

# 1.10.4 Dischi frangizolle

Discs



## Ricambi & accessori per macchine agricole

SPARE PARTS & ACCESSORIES FOR AGRICULTURAL MACHINE

Tutti gli articoli della presente sezione, prodotti da AMA SPA e/o da terzi per conto di AMA, sono adattabili ("non originali") alle marche indicate ai sensi di quanto previsto dal REG. CE n. 1400/2002. I diritti sui marchi citati appartengono ai legittimi proprietari ed il loro uso ha l'esclusiva finalità di consentire all'utilizzatore la comparazione dei diversi prodotti.  
All items of this section, manufactured by AMA SPA and/or any third party on behalf of AMA, are adaptable ("non-original") to the brands listed under the provisions of the REG. CE n. 1400/2002. The rights on the trademarks belong to their respective owners and their usage is only aimed to allow the user to compare different products.

## DISCHI FRANGIZOLLE CON FORO QUADRATO R600

DISQUES PULVERISEURS - TROU CARRÉ R600

DISCS - SQUARE HOLE R600

SCHEIBEN - VIERECKIGES LOCH R600

DISCOS DE GRADA - AGUJERO CUADRADO R600

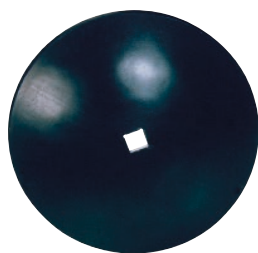

Art./Ref.	Diam. Pollici/ Inch Diam.	Diametro mm/ Diameter mm	Spessore mm/ Thickness mm	Foro mm/Hole mm	Concavità mm/ Concavity mm	Peso Kg/ Weight Kg	Note/Notes	Fornitore/null
CPL18Q26	16	410	3	26	37 (R600)	3.25	Liscio/smooth	D410LQ26S3A
CPD18Q26	16	410	3	26	37 (R600)	2.75	Dentato/toothed	D410DQ26S3A
CPL19Q26	18	460	3	26	46 (R600)	4	Liscio/smooth	D460LQ26S3A
CPD19Q26	18	460	3	26	46 (R600)	3.5	Dentato/toothed	D460DQ26S3A
CPL19Q31	18	460	3	31	46 (R600)	4	Liscio/smooth	D460LQ31S3A
CPD19Q31	18	460	3	31	46 (R600)	3.5	Dentato/toothed	D460DQ31S3A
CPD20Q23	20	510	3.5	23	57 (R600)	5.2	Dentato/toothed	D510DQ23S3S5A
CPL20Q26	20	510	3.5	26	57 (R600)	5.7	Liscio/smooth	D510LQ26S3S5A
CPD20Q26	20	510	3.5	26	57 (R600)	5.2	Dentato/toothed	D510DQ26S3S5A
CPL20Q31	20	510	3.5	31	57 (R600)	5.7	Liscio/smooth	D510LQ31S3S5A
CPD20Q31	20	510	3.5	31	57 (R600)	5.2	Dentato/toothed	D510DQ31S3S5A
CPL22Q26	22	560	4.5	26	68 (R600)	9	Liscio/smooth	D560LQ26S4S5A
CPD22Q26	22	560	4.5	26	68 (R600)	7.9	Dentato/toothed	D560DQ26S4S5A
CPL22Q29	22	560	4.5	29	68 (R600)	9	Liscio/smooth	D560LQ29S4S5A
CPD22Q29	22	560	4.5	29	68 (R600)	7.9	Dentato/toothed	D560DQ29S4S5A
CPL22Q31	22	560	4.5	31	68 (R600)	9	Liscio/smooth	D560LQ31S4S5A
CPD22Q31	22	560	4.5	31	68 (R600)	7.9	Dentato/toothed	D560DQ31S4S5A
CPL22Q33	22	560	4.5	33	68 (R600)	9	Liscio/smooth	D560LQ33S4S5A
CPD22Q33	22	560	4.5	33	68 (R600)	7.9	Dentato/toothed	D560DQ33S4S5A
CPL22Q41	22	560	4.5	41	68 (R600)	9	Liscio/smooth	D560LQ41S4S5A
CPD22Q41	22	560	4.5	41	68 (R600)	7.9	Dentato/toothed	D560DQ41S4S5A
CPL23Q31	24	610	5	31	84 (R600)	12	Liscio/smooth	D610LQ31S5A
CPD23Q31	24	610	5	31	84 (R600)	10.8	Dentato/toothed	D610DQ31S5A
CPL23Q33	24	610	5	33	84 (R600)	12	Liscio/smooth	D610LQ33S5A
CPD23Q33	24	610	5	33	84 (R600)	10.8	Dentato/toothed	D610DQ33S5A
CPL23Q41	24	610	5	41	84 (R600)	12	Liscio/smooth	D610LQ41S5A
CPD23Q41	24	610	5	41	84 (R600)	10.8	Dentato/toothed	D610DQ41S5A
CPL24Q31	24	610	6	31	84 (R600)	14.1	Liscio/smooth	D610L31S6A
CPD24Q31	24	610	6	31	84 (R600)	12.7	Dentato/toothed	D610D31S6A
CPL24Q33	24	610	6	33	84 (R600)	14.1	Liscio/smooth	D610LQ33S6A
CPD24Q33	24	610	6	33	84 (R600)	12.7	Dentato/toothed	D610DQ33S6A
CPL24Q41	24	610	6	41	84 (R600)	14.1	Liscio/smooth	D610LQ41S6A
CPD24Q41	24	610	6	41	84 (R600)	12.7	Dentato/toothed	D610DQ41S6A
CPL25Q33	26	660	6	33	100 (R600)	17.2	Liscio/smooth	D660LQ33S6A
CPD25Q33	26	660	6	33	100 (R600)	15.5	Dentato/toothed	D660DQ33S6A
CPL25Q41	26	660	6	41	100 (R600)	17.2	Liscio/smooth	D660LQ41S6A
CPD25Q41	26	660	6	41	100 (R600)	15.5	Dentato/toothed	D660DQ41S6A
CPL26Q41	28	710	7	41	117 (R600)	27.2	Liscio/smooth	D710LQ41S7A
CPD26Q41	28	710	7	41	117 (R600)	23.5	Dentato/toothed	D710DQ41S7A

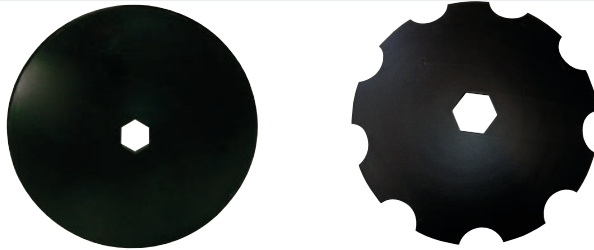
**DISCHI FRANGIZOLLE - FORO ESAGONALE R600**
*DISQUES PULVERISEURS - TROU HEXAGONAL R600*
*DISCS - HEXAGONAL HOLE R600*
*SCHEIBEN - SECHSECKIGES LOCH R600*
*DISCOS DE GRADA - AGUJERO EXAGONAL R600*

Art./Ref.	Diam. Pollici/ Inch Diam.	Diametro mm/ Diameter mm	Spessore mm/ Thickness mm	Foro mm/ Hole mm	Concavità mm/ Concavity mm	Peso Kg/ Weight Kg	Note/Notes	Fornitore/null
CPL19E67	18	460	3	67	46 (R600)	4.2	Liscio/smooth	D460LE67S3A
CPD19E67	18	460	3	67	46 (R600)	3.8	Dentato/toothed	D460DE67S3A
CPL20E67	20	510	3.5	67	57 (R600)	4.2	Liscio/smooth	D510LE67S35A
CPD20E67	20	510	3.5	67	57 (R600)	3.8	Dentato/toothed	D510DE67S35A
CPL22E67	22	560	4.5	67	68 (R600)	9	Liscio/smooth	D560LE67S45A
CPD22E67	22	560	4.5	67	68 (R600)	7.9	Dentato/toothed	D560DE67S45A
CPL22E92	22	560	4.5	92	68 (R600)	9	Liscio/smooth	D560LE92S45A
CPD22E92	22	560	4.5	92	68 (R600)	7.9	Dentato/toothed	D560DE92S45A
CPL23E67	24	610	5	67	84 (R600)	12	Liscio/smooth	D610LE67S5A
CPD23E67	24	610	5	67	84 (R600)	10.8	Dentato/toothed	D610DE67S5A
CPL23E89	24	610	5	89	84 (R600)	12	Liscio/smooth	D610LE89S5A
CPD23E89	24	610	5	89	84 (R600)	10.8	Dentato/toothed	D610DE89S5A
CPL23E92	24	610	5	92	84 (R600)	12	Liscio/smooth	D610LE92S5A
CPD23E92	24	610	5	92	84 (R600)	10.8	Dentato/toothed	D610DE92S5A
CPL24E67	24	610	6	67	84 (R600)	12	Liscio/smooth	D610LE67S6A
CPD24E67	24	610	6	67	84 (R600)	10.8	Dentato/toothed	D610DE67S6A
CPL24E89	24	610	6	89	84 (R600)	12	Liscio/smooth	D610LE89S6A
CPD24E89	24	610	6	89	84 (R600)	10.8	Dentato/toothed	D610DE89S6A
CPL24E92	24	610	6	92	84 (R600)	12	Liscio/smooth	D610LE92S6A
CPD24E92	24	610	6	92	84 (R600)	10.8	Dentato/toothed	D610DE92S6A

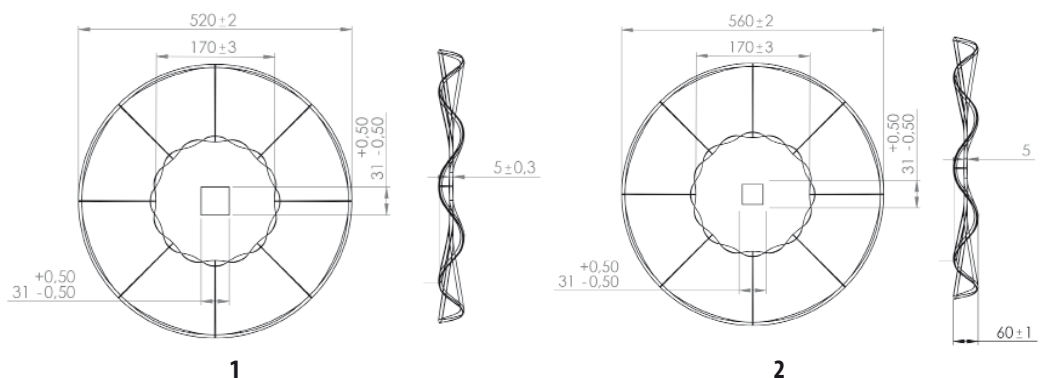
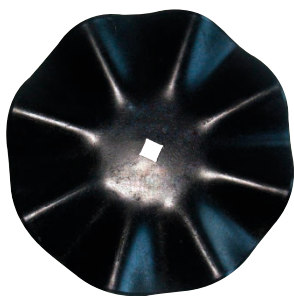
**DISCO ONDULATO CON FORO QUADRATO**
*DISQUE ONDULE' AVEC TROU CARRE'*
*UNDULATED DISC WITH SQUARE HOLE*
*GEWELLTE SECHSCHEIBE*
*DISCO ONDULADO CON AGUJERO CUADRADO*

Art./Ref.	Pos.	Diametro mm/ Diameter mm	Spessore mm/ Thickness mm	Foro mm/Hole mm	Peso Kg/Weight Kg	Fornitore/null
CP2255	1	520	5	31	8,4	D0520LQ31S5A
CP2257	2	560	5	31	9,7	D0560LQ31S5A

**DISCHI PER COLTIVATORE ADATTABILI VERDEGIGLIO**

DISQUES POUR COLTIVATEUR ADAPTABLES VERDEGIGLIO  
 CULTIVATOR DISCS SUITABLES VERDEGIGLIO  
 EGGENSCHIEBEN PASSEND VERDEGIGLIO  
 DISCOS DE CULTIVADOR ADAPTABLES VERDEGIGLIO

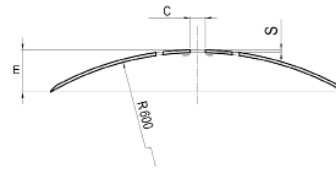
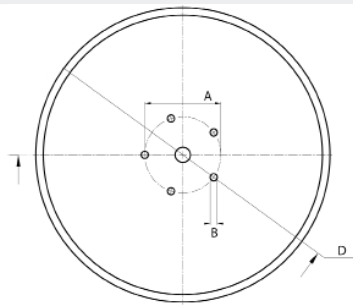

Art./Ref.	A mm	B mm	C mm	D mm	E mm	Spessore mm/Thickness mm	Note/Notes	Fornitore/null
CP1440C	155	14.5	31	560	74	6	Fori cilindrici/cylindrical holes	D560LT31F5S6A
CP1440CS	155	14.5	31	560	74	6	Fori svasati/countersunk holes	D560LT31F5S56A
CP1441C	155	14.5	31	610	90	6	Fori cilindrici/cylindrical holes	D610LT31F5S6A
CP1441CS	155	14.5	31	610	90	6	Fori svasati/countersunk holes	D610LT31F5S56A

**DISCHI PER ARATRO**

DISQUES POUR CHARRUE  
 PLOUGH DISCS  
 PFLUGSCHEIBEN  
 DISCOS DE ARADO

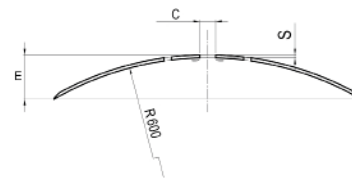
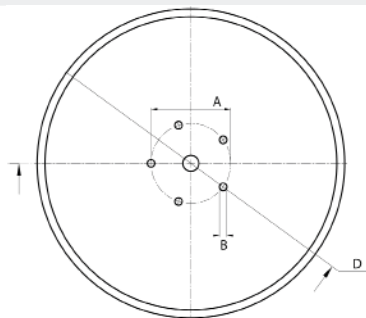

Art./Ref.	A mm	B mm	C mm	D mm	E mm	Spessore mm/Thickness mm	Note/Notes	Fornitore/null
CP1440L	210	13.5	26	560	74	6	Fori svasati/countersunk holes	D560LT26F5S56A
CP1441L	210	14.5	26	610	90	6	Fori svasati/countersunk holes	D610LT26F5S56A
CP1442L	260	16.5	26	660	106	6	Fori svasati/countersunk holes	D660LT26F5S56A
CP1443L	260	16.5	26	710	123	6	Fori svasati/countersunk holes	D710LT26F5S56A

**DISCHI PIANI**

DISQUES PLANS  
 SMOOTHED DISCS  
 EGGENSCHIEBEN GLATT  
 DISCOS LLANOS

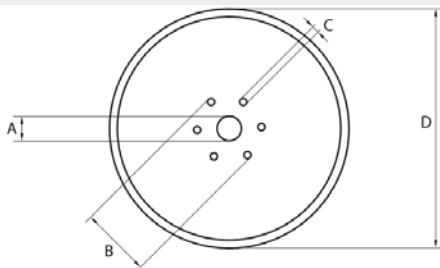

Art./Ref.	A mm	B mm	C mm	D mm	Spessore mm/Thickness mm	Peso Kg/Weight Kg	Note/Notes	Fornitore/null
CP1527	110	165	13	400	6 mm	5.7	Fori cilindrici/cylindrical holes	D400LP7F56A
CP1528	110	165	13	450	6 mm	6.8	Fori cilindrici/cylindrical holes	D450LP7F56A
CP1529	110	165	13	500	6 mm	8.6	Fori cilindrici/cylindrical holes	D500LP7F56A

**DISCHI PER FRANGIZOLLE ADATTABILI AGROMET**

DISQUES ADAPTABLE A' AGROMET

DISCS FITS AGROMET

SCHEIBEN AGROMET

DISCOS DE GRADA AGROMET

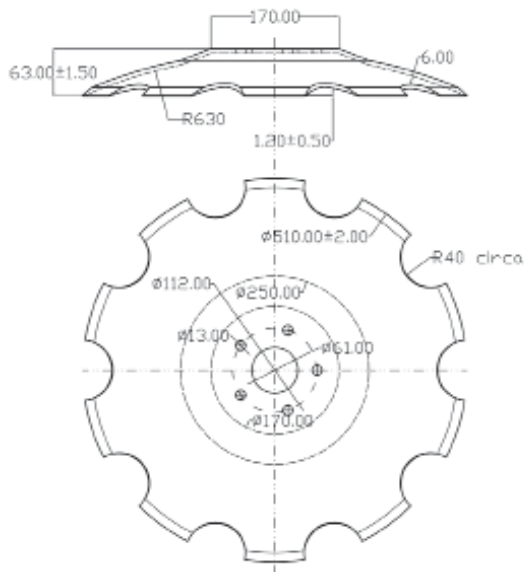

Art./Ref.	Diametro mm/ Diameter mm	Diam. Pollici/ Inch Diam.	Spessore mm/ Thickness mm	Foro mm/ Hole mm	Concavità mm/ Concavity mm	Note/Notes
DAGR11I	510	20	6	61	63	DENTATO - N. 5 FORI Ø 13 SU CIRC. 112
DAGR21I	560	22	6	61	70	DENTATO - N. 5 FORI Ø 13 SU CIRC. 112
DAGRO1I	610	24	6	61	84	DENTATO - N. 5 FORI Ø 13 SU CIRC. 112
DAGR31I	660	26	6	61	100	DENTATO - N. 5 FORI Ø 13 SU CIRC. 112

**DISCO ADATTABILE BDM AGRO CAMOMILLA**

DISQUE ADAPTABLE BDM AGRO CAMOMILLA

DISC SUITABLE BDM AGRO CAMOMILLA MODEL

SCHEIBEN PASSEND ZU BDM AGRO CAMOMILLA

DISCOS ADAPTABLE BDM AGRO CAMOMILLA

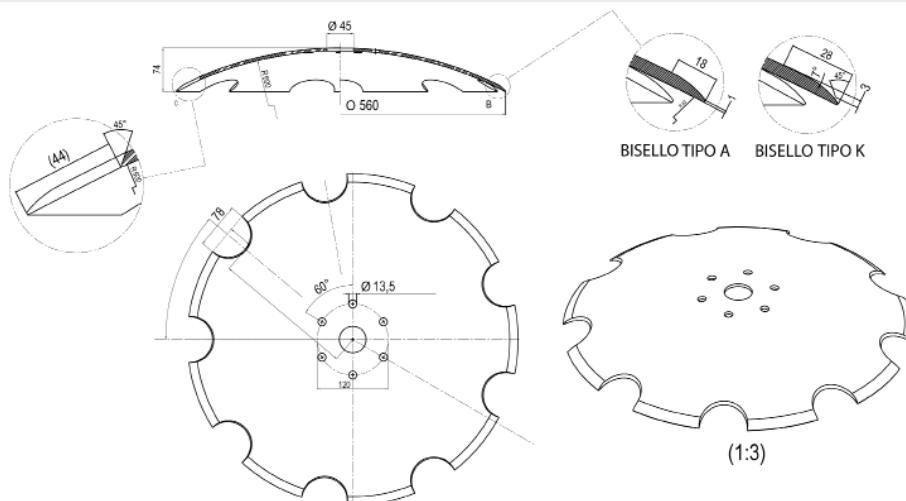

**NOTE:** Per quantità consistenti possiamo realizzare dischi con diametri e forature come disegno del cliente.

**NOTES:** for high volumes, we are available to produce discs with customized diameter and holes.

Art./Ref.	Diametro mm/ Diameter mm	Spessore mm/ Thickness mm	Foro mm/ Hole mm	Concavità mm/ Concavity mm	Note	Fornitore/null
CP6207A	560	5 mm	45	74	Disco con n.6 fori da 13,5 mm ,interasse 120 mm. Bisello tipo A	D560DT45F135S5A
CP6214A	560	5 mm	45	74	Disco con n.6 fori da 13,5 mm ,interasse 120 mm. Bisello tipo K	D560DT45F135S5K
CP6207	560	6 mm	45	75	Disco con n.6 fori da 13,5 mm ,interasse 120 mm. Bisello tipo A	D560DT45F135S6A
CP6214	560	6 mm	45	75	Disco con n.6 fori da 13,5 mm ,interasse 120 mm. Bisello tipo K	D560DT45F135S6K

**DISCHI PER FRANGIZOLLE ADATTABILI AMAZONE**

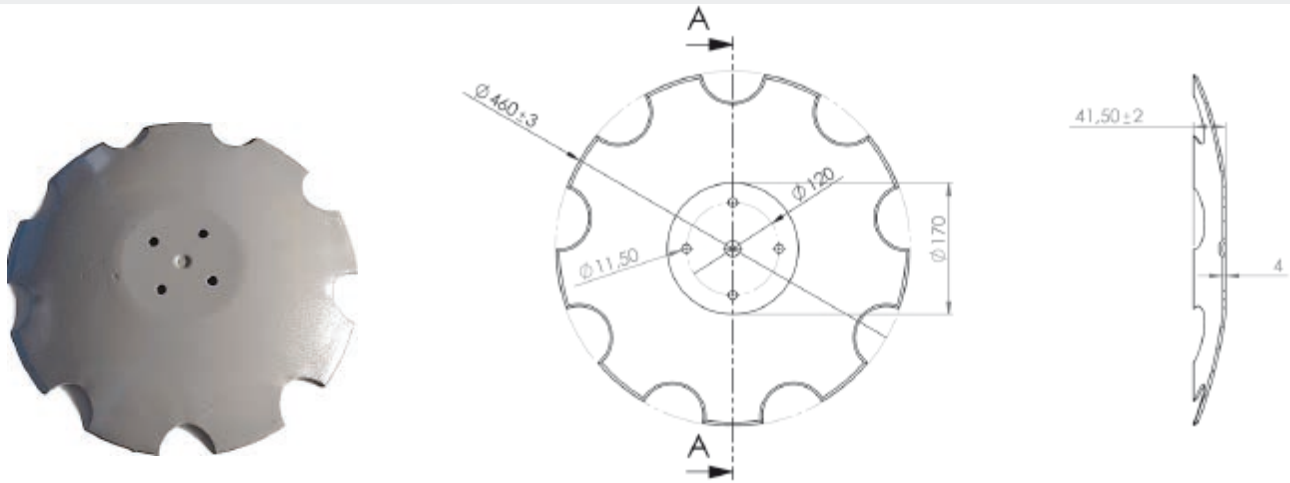
DISQUES ADAPTABLE A' AMAZONE  
DISCS FITS AMAZONE  
SCHEIBEN AMAZONE  
DISCOS DE GRADA AMAZONE



Art./Ref.	Diametro mm/ Diameter mm	Diam. Pollici/ Inch Diam.	Spessore mm/ Thickness mm	Concavità mm/ Concavity mm	Note/Notes	Rif. Orig./Orig. Ref.
D460D4F11S4A	460	18	4	41,5	DENTATO - N. 4 FORI $\phi$ 11,5 SU CIRC. 120	XL043
D460D4F11S4A	460	18	4	41,5	DENTATO - N. 4 FORI $\phi$ 11,5 SU CIRC. 110	XL034

**DISCHI PER FRANGIZOLLE ADATTABILI AMAZONE**

DISQUES ADAPTABLE A' AMAZONE  
DISCS FITS AMAZONE  
SCHEIBEN AMAZONE  
DISCOS DE GRADA AMAZONE

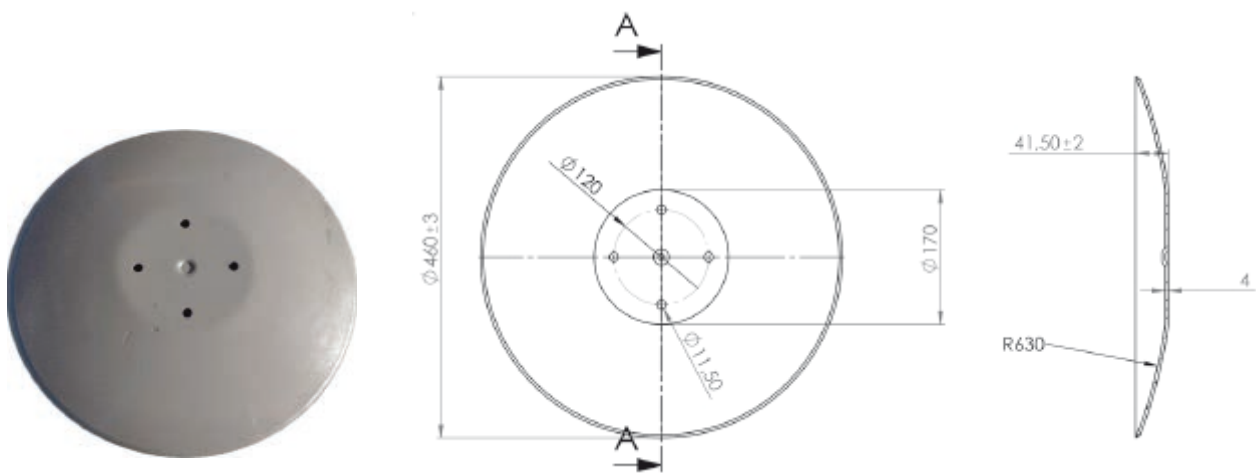

Art./Ref.	Diametro mm/ Diameter mm	Diam. Pollici/ Inch Diam.	Spessore mm/ Thickness mm	Concavità mm/ Concavity mm	Note/Notes	Rif. Orig./Orig. Ref.
D460L4F11S4A	460	18	4	41,5	LISCIO - N. 4 FORI $\phi$ 11,5 SU CIRC. 120	XL041
D460L4F11S4M1A	460	18	4	41,5	LISCIO - N. 4 FORI $\phi$ 11,5 SU CIRC. 110	XL011

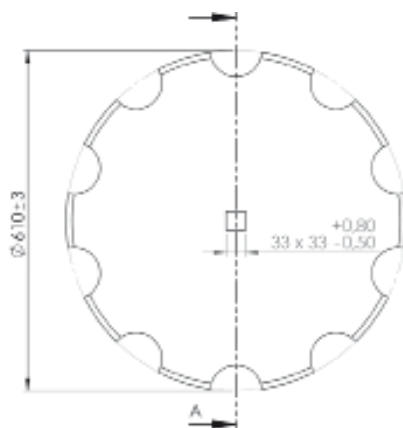

**DISCHI PER FRANGIZOLLE ADATTABILI JOHN DEERE**
*DISQUE ADAPTABLE A' JOHN DEERE*
*DISCS FITS TO JOHN DEERE*
*SCHEIBEN JOHN DEERE*
*DISCOS DE GRADA JOHN DEERE*

 SEZIONE A-A  
SCALA 1 : 5

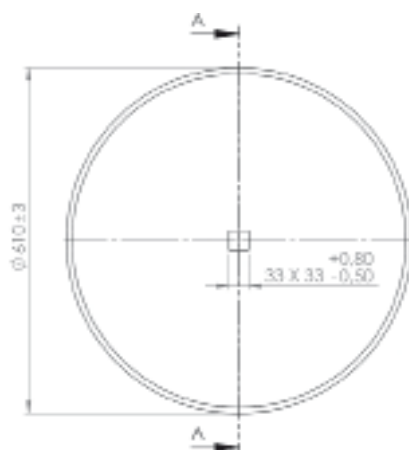
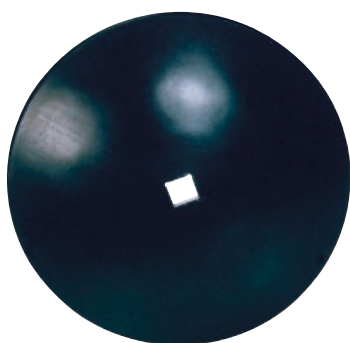
Art./Ref.	Diametro mm/ Diameter mm	Diam. Pollici/Inch Diam.	Spessore mm/ Thickness mm	Foro mm/Hole mm	Concavità mm/ Concavity mm	Note/Notes
D610DQ33S5A	610	24	5	33	89	dentato
D610DQ33S6A	610	24	6	33	90	

**DISCHI PER FRANGIZOLLE ADATTABILI JOHN DEERE**
*DISQUE ADAPTABLE A' JOHN DEERE*
*DISCS FITS JOHN DEERE*
*SCHEIBEN JOHN DEERE*
*DISCOS DE GRADA JOHN DEERE*

 SEZIONE A-A  
SCALA 1 : 5

Art./Ref.	Diametro mm/ Diameter mm	Diam. Pollici/Inch Diam.	Spessore mm/ Thickness mm	Foro mm/Hole mm	Concavità mm/ Concavity mm	Note/Notes
D610LQ33S5A	610	24	5	33	89	LISCIO

**DISCHI PER FRANGIZOLLE ADATTABILI JOHN DEERE**

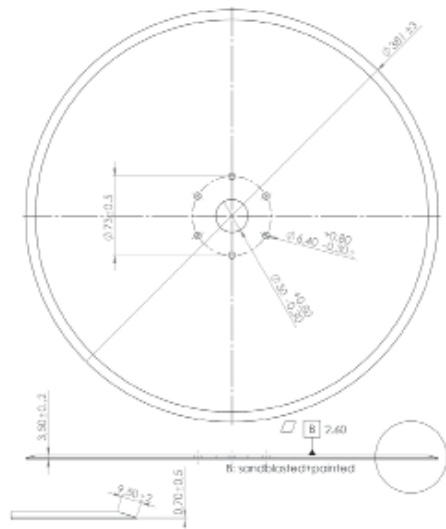
DISQUES ADAPTABLE A' JOHN DEERE  
DISCS FITS JOHN DEERE  
SCHEIBEN JOHN DEERE  
DISCOS DE GRADA JOHN DEERE



Art./Ref.	Diametro mm/ Diameter mm	Diam. Pollici/ Inch Diam.	Spessore mm/ Thickness mm	Foro mm/Hole mm	Concavità mm/ Concavity mm	Note/Notes
DJSC381LP6F535A	381	15	3,5	30		PIANO + 6 FORI Ø 6,4 SU CIRC. 73

**DISCHI PER FRANGIZOLLE ADATTABILI HORSCH**

DISQUES PULVERISEURS ADAPTABLE A' HORSCH  
DISCS FITS HORSCH  
SCHEIBEN HORSCH  
DISCOS DE GRADA HORSCH

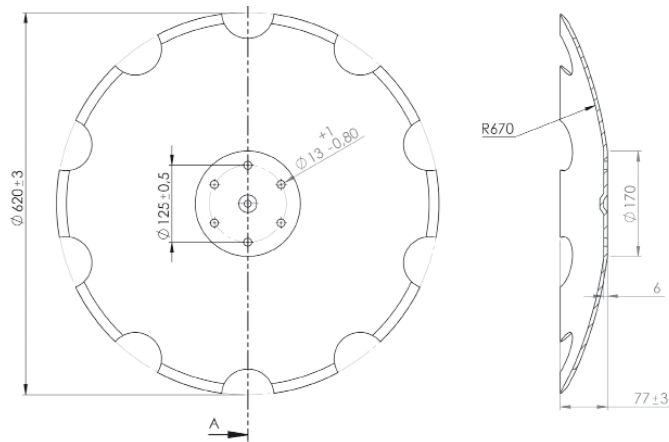

Art./Ref.	Diametro mm/ Diameter mm	Diam. Pollici/ Inch Diam.	Spessore mm/ Thickness mm	Concavità mm/ Concavity mm	Note/Notes	Rif. Orig./Orig. Ref.
DHRS620D6F56A	620	24,4	6	77	DENTATO 3 FORI Ø 13 SU CIRC.97	00311103

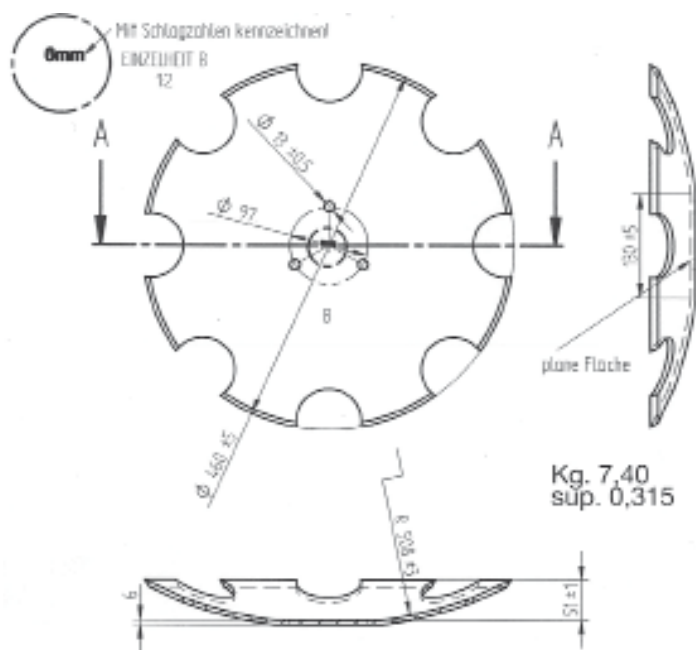

**DISCHI PER FRANGIZOLLE ADATTABILI HORSCH**
*DISQUES ADAPTABLE A' HORSCH*
*DISCS FITS HORSCH*
*SCHEIBEN HORSCH*
*DISCOS DE GRADA HORSCH*

Art./Ref.	Diametro mm/ Diameter mm	Diam. Pollici/ Inch Diam.	Spessore mm/ Thickness mm	Concavità mm/ Concavity mm	Note/Notes	Rif. Orig./Orig. Ref.
DHR01A	460	18	6	51	DENTATO 3 FORI Ø 13 SU CIRC. 97	23246106
DHR02A	460	18	4	51	DENTATO 3 FORI Ø 13 SU CIRC. 97	23246102

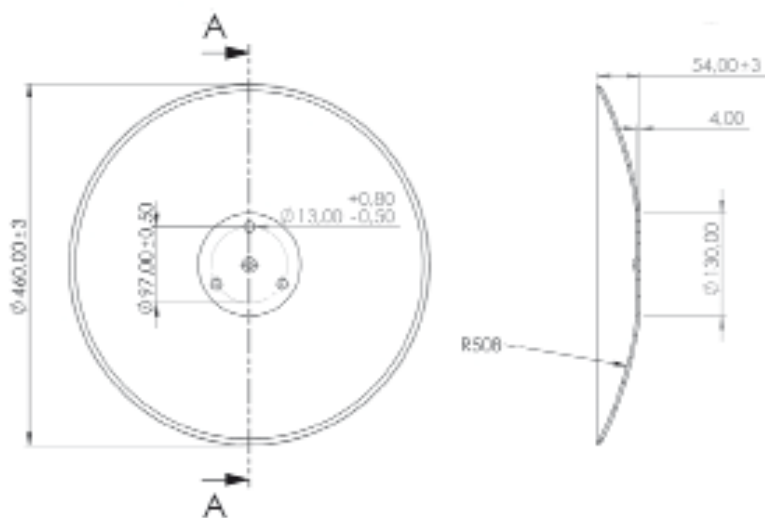
**DISCHI PER FRANGIZOLLE ADATTABILI HORSCH**
*DISQUES ADAPTABLE A' HORSCH*
*DISCS FITS HORSCH*
*SCHEIBEN HORSCH*
*DISCOS DE GRADA HORSCH*

Art./Ref.	Diametro mm/ Diameter mm	Diam. Pollici/ Inch Diam.	Spessore mm/ Thickness mm	Concavità mm/ Concavity mm	Note/Notes	Rif. Orig./Orig. Ref.
DHR04A	460	18	4	51	LISCIO 3 FORI Ø 13 SU CIRC. 97	24251103

**DISCHI PER FRANGIZOLLE ADATTABILI HORSCH**

DISQUES ADAPTABLE A' HORSCH  
DISCS FITS HORSCH  
SCHEIBEN HORSCH  
DISCOS DE GRADA HORSCH

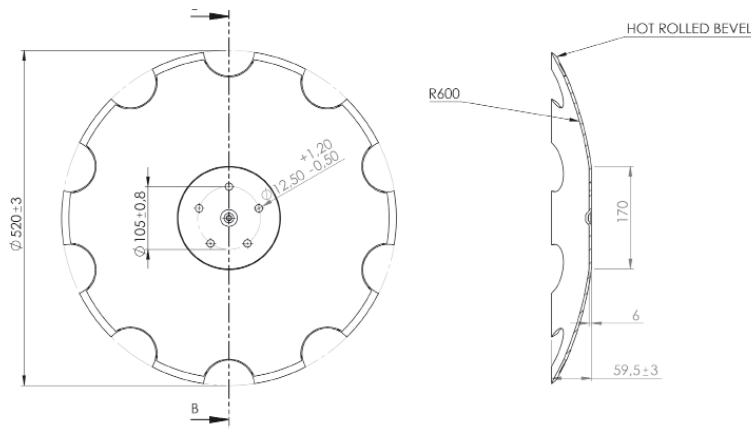

Art./Ref.	Diametro mm/ Diameter mm	Diam. Pollici/ Inch Diam.	Spessore mm/ Thickness mm	Concavità mm/Conca- vity mm	Note/Notes	Rif. Orig./Orig. Ref.
DHR5520D5FS6A	520	20	6	59,5	DENTATO 5 FORI ø 12,5 SU CIRC. 105	28071305

**DISCHI PER FRANGIZOLLE ADATTABILI KVERNELAND**

DISQUES ADAPTABLE A' KVERNELAND  
DISCS FITS KVERNELAND  
SCHEIBEN KVERNELAND  
DISCOS DE GRADA KVERNELAND

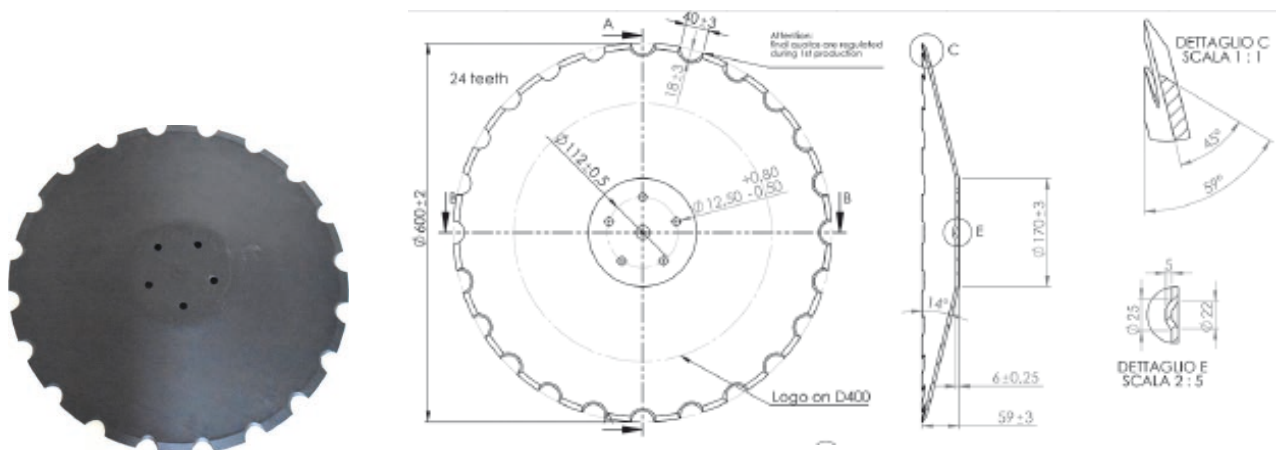

Art./Ref.	Diametro mm/ Diameter mm	Diam. Pollici/ Inch Diam.	Spessore mm/ Thickness mm	Concavità mm/ Concavity mm	Note/Notes	Rif. Orig./Orig. Ref.
DKVE01D600S6A	600	23,6	6	59	CONICO + 5 FORI ø 12,5 SU CIRC. 112	RF2931700

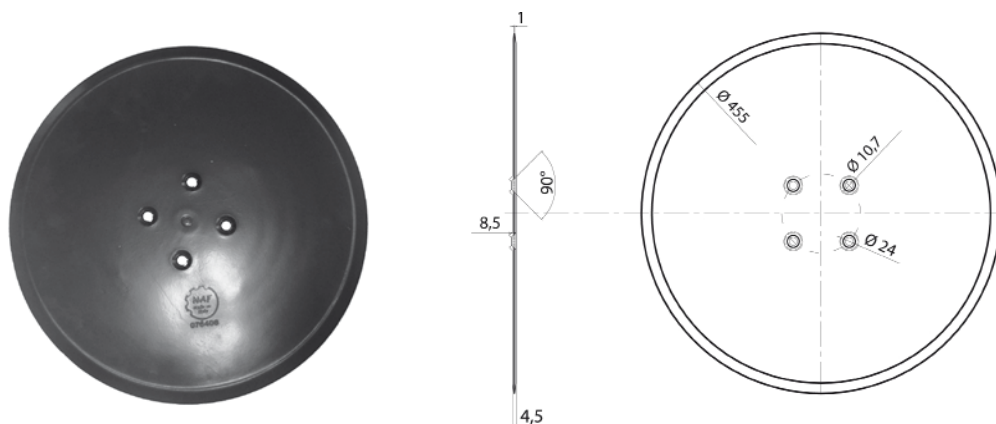
**DISCHI PER COLTIVATORE ADATTABILE KVERNELAND**
*DISQUES POUR COLTIVATEUR ADAPTABLE A KVERNELAND*
*CULTIVATOR DISCS SUITABLE TO KVERNELAND*
*EGGENSCHEIBEN PASSEND ZU KVERNELAND*
*DISCOS DE CULTIVADOR ADAPTABLE A KVERNELAND*

Art./Ref.	Diametro mm/ Diameter mm	Spessore mm/ Thickness mm	Foro mm/ Hole mm	Concavità mm/ Concavity mm	Note/Notes	Brand	Fornitore/null	Rif. Orig./ Orig. Ref.
<b>RC1852</b>	455	4.5		PIANO	n.4 fori da 10.7 bugnati	NUOVA AZZIMONDI & FR - KVERNELAND	DKVN02A	076406

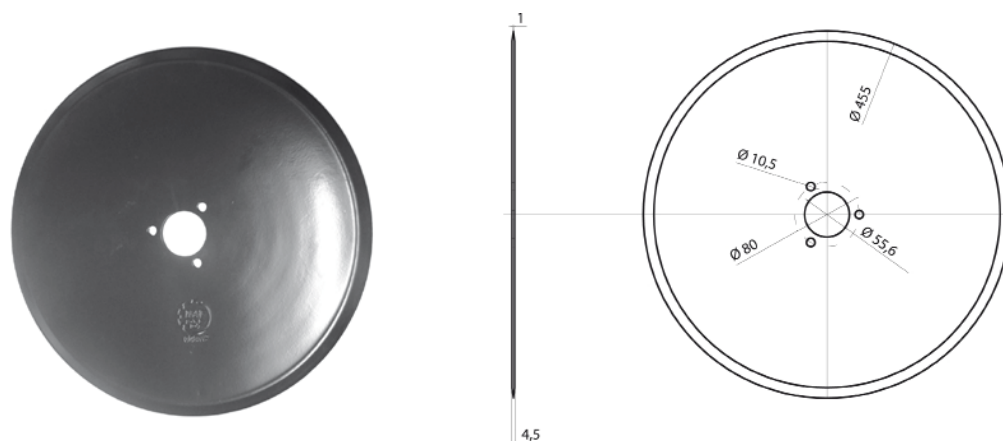
**DISCHI PER COLTIVATORE ADATTABILE KVERNELAND**
*DISQUES POUR COLTIVATEUR ADAPTABLE A KVERNELAND*
*CULTIVATOR DISCS SUITABLE TO KVERNELAND*
*EGGENSCHEIBEN PASSEND ZU KVERNELAND*
*DISCOS DE CULTIVADOR ADAPTABLE A KVERNELAND*

Art./Ref.	Diametro mm/ Diameter mm	Spessore mm/ Thickness mm	Foro mm/Hole mm	Concavità mm/ Concavity mm	Note/Notes	Brand	Rif. Orig./ Orig. Ref.	Fornitore/null
<b>RC1851</b>	455	4.5 MM	55.6	PIANO	n.3 fori da 10.5 su circ. 80.	KVERNELAND	056112	<b>DKVN01A</b>

**DISCO ADATTABILE LEMKEN 620 MM**

DISQUE ADAPTABLE LEMKEN 620 MM  
 DISC SUITABLE TO LEMKEN 620 MM  
 SCHEIBEN PASSEND ZU LEMKEN 620 MM  
 DISCOS ADAPTABLE LEMKEN 620 MM

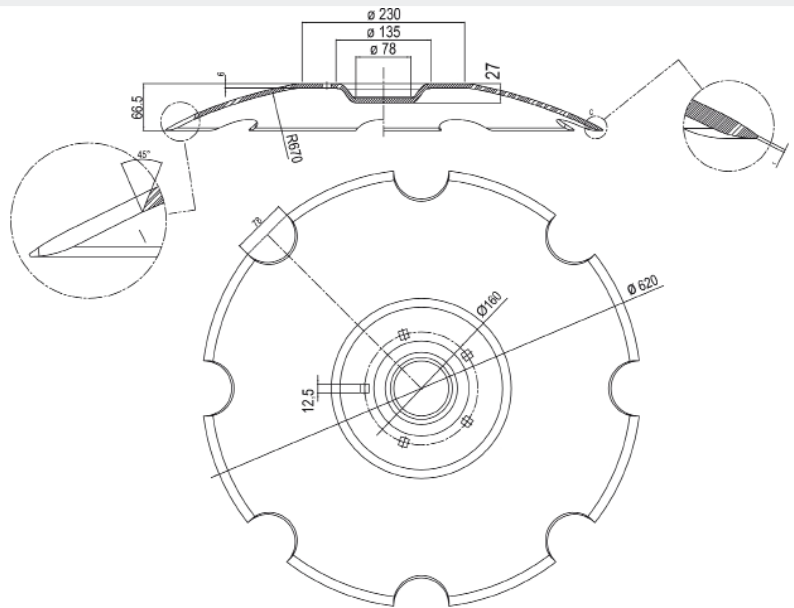

Per quantità consistenti possiamo realizzare dischi con diametri e forature come disegno del cliente.  
 FOR HIGH VOLUMES, WE ARE AVAILABLE TO PRODUCE DISCS WITH CUSTOMIZED DIAMETER AND HOLES.

Art./Ref.	Diametro mm/ Diameter mm	Spessore mm/ Thickness mm	Concavità mm/ Concavity mm	Note/Notes	Brand	Rif. Orig./Orig. Ref.	Fornitore/null
CP6210	620	6 mm	60,5 mm	N.5 fori quadri da 12,6 mm ,interasse 160 mm	LEMKEN	3490467	DUNI11A

**DISCO ADATTABILE LEMKEN 620 MM**

DISQUE ADAPTABLE LEMKEN 620 MM  
 DISC SUITABLE TO LEMKEN 620 MM  
 SCHEIBEN PASSEND ZU LEMKEN 620 MM  
 DISCOS ADAPTABLE LEMKEN 620 MM

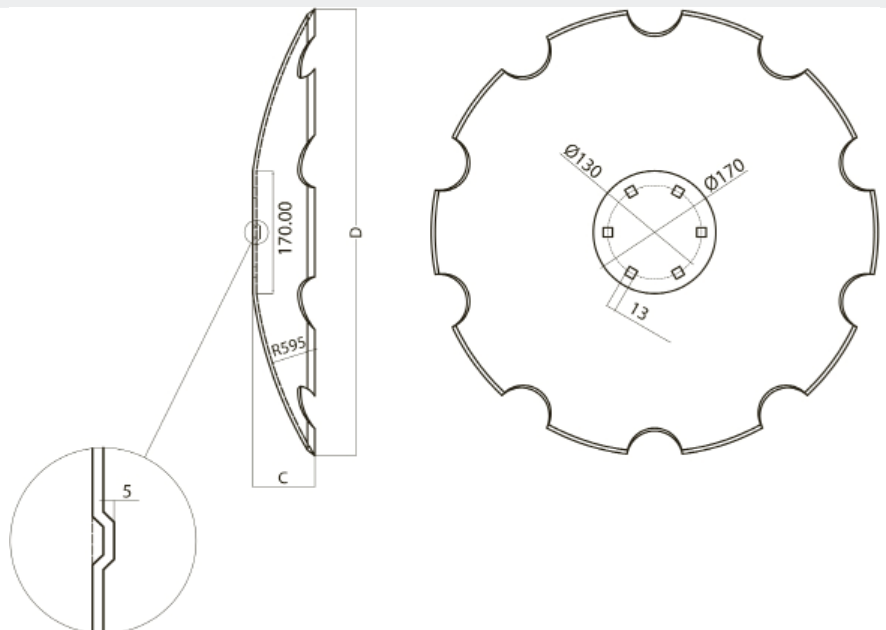

**Note:** Per quantità consistenti possiamo realizzare dischi con diametri e forature come disegno del cliente.

**Notes:** for high volumes, we are available to produce discs with customized diameter and holes.

Art./Ref.	Diametro mm/ Diameter mm	Spessore mm/ Thickness mm	Concavità mm/ Concavity mm	Note/Notes	Brand	Rif. Orig./Orig. Ref.	Fornitore/null
CP6209	620	5 mm	81 mm	N.6 fori quadri da 13 mm ,interasse 130 mm con base piana da 170 mm	LEMKEN	3490466	DLMK01A

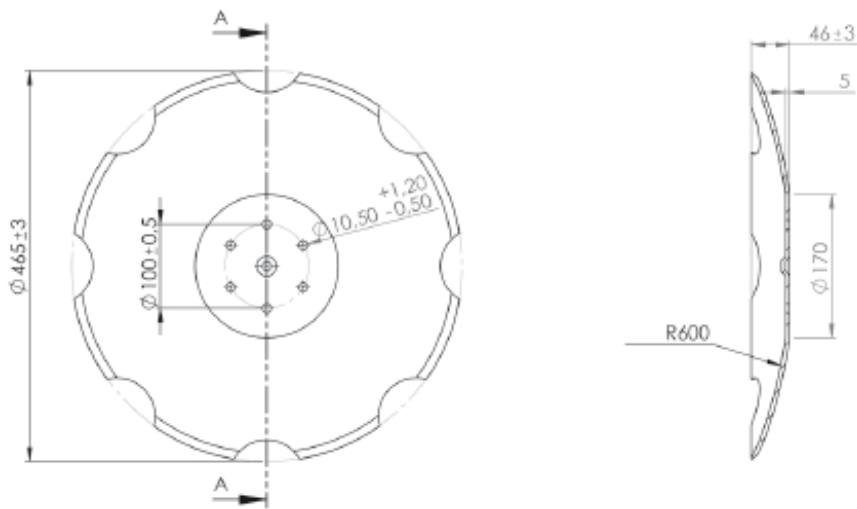
**DISCHI PER FRANGIZOLLE ADATTABILI LEMKEN**
*DISQUES ADAPTABLE A' LEMKEN*
*DISCS FITS LEMKEN*
*SCHEIBEN PASSEND FUER LEMKEN*
*DISCOS DE GRADA LEMKEN*

Art./Ref.	Diametro mm/ Diameter mm	Diam. Pollici/ Inch Diam.	Spessore mm/ Thickness mm	Concavità mm/ Concavity mm	Note/Notes	Rif. Orig./Orig. Ref.
<b>DLMK460D6F55A</b>	465	18	5	46	DENTATO - N. 6 FORI Ø 10,5 SU CIRC. 100	3490471

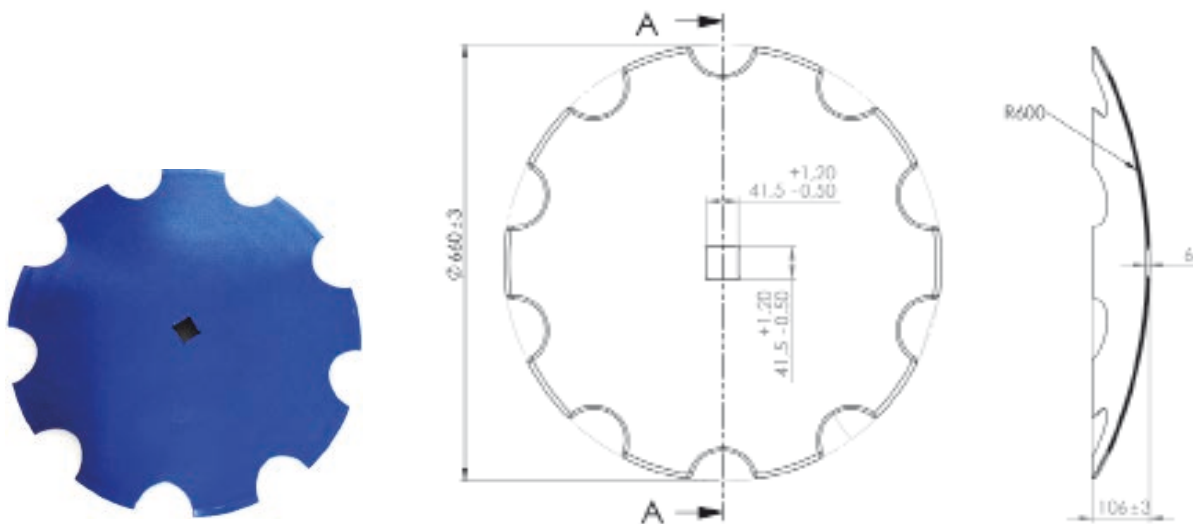
**DISCHI PER FRANGIZOLLE ADATTABILI GREGOIRE BESSON**
*DISQUES ADAPTABLE A' GREGOIRE BESSON*
*DISCS FITS GREGOIRE BESSON*
*SCHEIBEN PASSEND FUER GREGOIRE BESSON*
*DISCOS DE GRADA GREGOIRE BESSON*

Art./Ref.	Diametro mm/ Diameter mm	Diam. Pollici/ Inch Diam.	Spessore mm/ Thickness mm	Foro mm/ Hole mm	Concavità mm/ Concavity mm	Rif. Orig./Orig. Ref.
<b>D660DQ41S6A</b>	660	26	6	41	106	851000998
<b>D660DQ41S7A</b>	660	26	7	41	106	851001198

**DISCHI PER FRANGIZOLLE ADATTABILI GREGOIRE BESSON**

DISQUES ADAPTABLE A' GREGOIRE BESSON

DISCS FITS GREGOIRE BESSON

SCHEIBEN PASSEND FUER GREGOIRE BESSON

DISCOS DE GRADA GREGOIRE BESSON

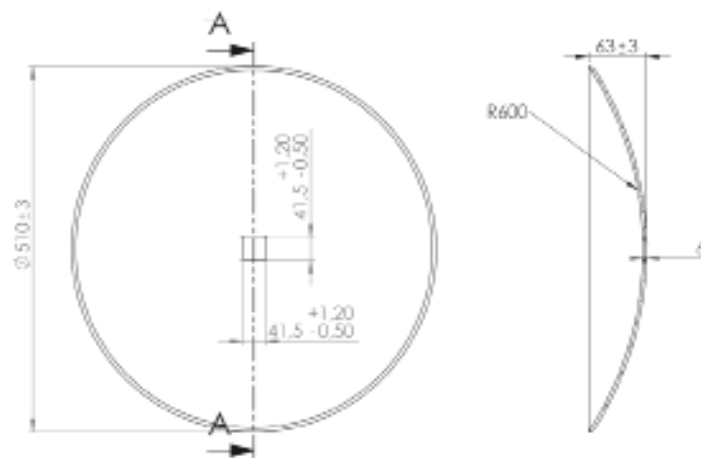
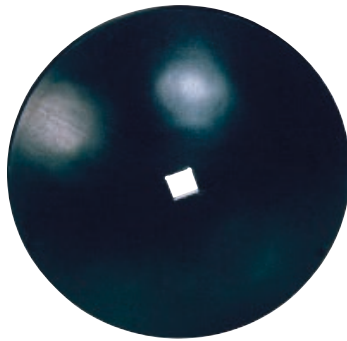

Art./Ref.	Diametro mm/ Diameter mm	Diam. Pollici/ Inch Diam.	Spessore mm/ Thickness mm	Foro mm/ Hole mm	Concavità mm/ Concavity mm	Rif. Orig./Orig. Ref.
D510LQ41S6A	510	20	6	41	63	851002098
D660LQ41S6A	660	26	6	41	106	851001098
D660LQ41S7A	660	26	7	41	106	850001298

**DISCHI PER FRANGIZOLLE ADATTABILI MOZZO SKF INT. 98 - 4 FORI**

DISQUES ADAPTABLE A' MOYEU SKF Ø 98 - 4 TROUS

DISCS FITS HUB SKF Ø 98 - 4 HOLES

SCHEIBEN PASSEND FUER SKF Ø 98 - 4 HOLES

DISCOS DE ROTURADOR ADAPTABLES EJE SKF Ø 98 - 4 AGUJEROS

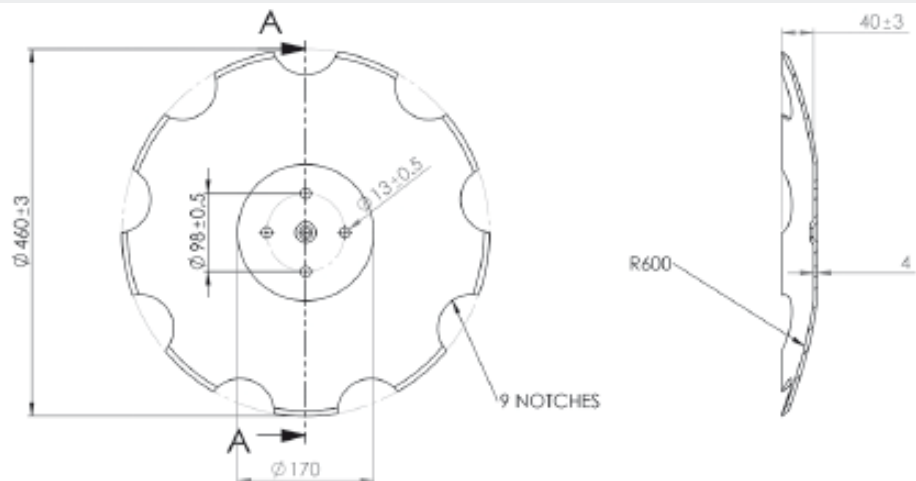

Art./Ref.	Diametro mm/ Diameter mm	Diam. Pollici/ Inch Diam.	Spessore mm/ Thickness mm	Concavità mm/ Concavity mm	Note/Notes
D460DBP4FS4A	460	18	4	40	DENTATO - N. 4 FORI Ø 13 SU CIRC. 98 (skf)
D460LBP4FS4A	460	18	4	40	LISCIO - N. 4 FORI Ø 13 SU CIRC. 98 SKF
D510DBP4FS4A	510	20	4	51	DENTATO - N. 4 FORI Ø 13 SU CIRC. 98 SKF
D510LBP4FS5R63A	510	20	5	53	LISCIO - N. 4 FORI Ø 13 SU CIRC. 98 SKF
D560D4FBP55A	560	22	5	63	DENTATO - N. 4 FORI Ø 13 SU CIRC. 98 SKF
D560D4FBP56A	560	22	6	63	DENTATO - N. 4 FORI Ø 13 SU CIRC. 98 SKF
D610D4FBP55A	610	24	5	78	DENTATO - N. 4 FORI Ø 13 SU CIRC. 98 SKF
D610D4FBP56A	610	24	6	78	DENTATO - N. 4 FORI Ø 13 SU CIRC. 98 SKF

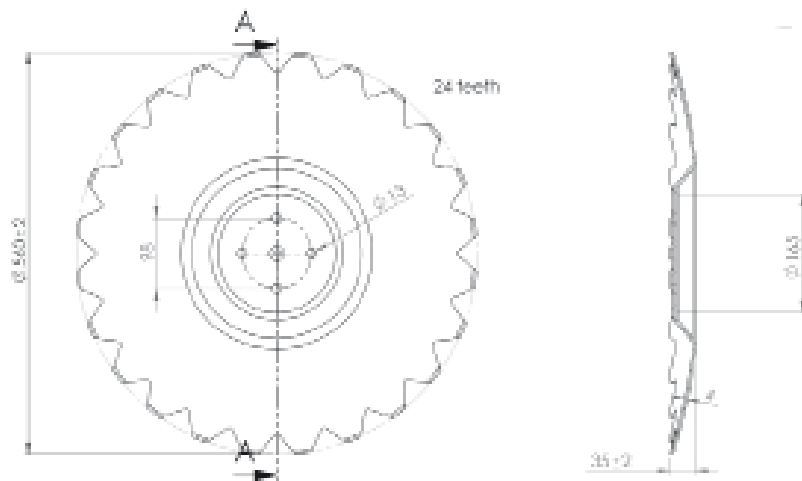
**DISCHI PER FRANGIZOLLE ADATTABILI MOZZO SKF INT. 98 - 4 FORI - DENTATURA SPECIALE CON BUGNATURA**
*DISQUES ADAPTABLE A' MOYEU SKF Ø 98 - 4 TROUS - CRENELE' AVEC BOSSAGE*
*DISCS FITS HUB SKF Ø 98 - 4 HOLES - NOTCHED*
*SCHEIBEN PASSEND FUER SKF LAGER*
*DISCOS DE ROTURADOR ADAPTABLES EJE SKF Ø 98 - 4 AGUJEROS - DIENTES Y FORMA ESPECIALES*

Art./Ref.	Diametro mm/ Diameter mm	Diam. Pollici/ Inch Diam.	Spessore mm/ Thickness mm	Concavità mm/ Concavity mm	Note/Notes
DINT560F4S4BA	560	22	4	35	DENTATO CON BUGNATURA - N. 4 FORI Ø 13 SU CIRC. 98 SKF

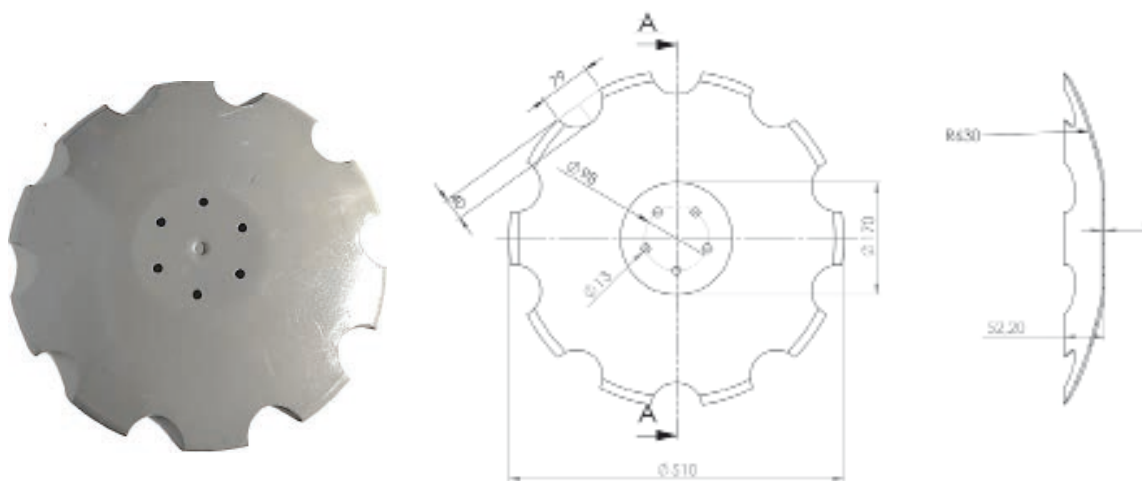
**DISCHI PER FRANGIZOLLE ADATTABILI MOZZO SKF INT. 98 - 5 FORI**
*DISQUES ADAPTABLE A' MOYEU SKF Ø 98 - 5 TROUS*
*DISCS FITS HUB SKF Ø 98 - 5 HOLES*
*SCHEIBEN PASSEND FUER SKF LAGER*
*DISCOS DE ROTURADOR ADAPTABLES EJE SKF Ø 98 - 5 AGUJEROS*

Art./Ref.	Diametro mm/ Diameter mm	Diam. Pollici/ Inch Diam.	Spessore mm/ Thickness mm	Concavità mm/ Concavity mm	Note/Notes
D510DBP5FS4R63A	510	20	4	52	DENTATO - N. 5 FORI Ø 13 SU CIRC. 98 SKF
D560DBP5FS4R63A	560	22	4	60	DENTATO - N. 5 FORI Ø 13 SU CIRC. 98 SKF
D610DBP5FS5R63A	610	24	5	73	DENTATO - N. 5 FORI Ø 13 SU CIRC. 98 SKF
D610DBP5FS6R63A	610	24	6	73	DENTATO - N. 5 FORI Ø 13 SU CIRC. 98 SKF



**DISCHI PER FRANGIZOLLE ADATTABILI MOZZO SKF INT. 98 - 6 FORI**

DISQUES ADAPTABLE A' MOYEU SKF Ø 98 - 6 TROUS  
 DISCS FITS HUB SKF Ø 98 - 6 HOLES  
 SCHEIBEN PASSEND FUER SKF LAGER  
 DISCOS DE ROTURADOR ADAPTABLES EJE SKF Ø 98 - 6 AGUJEROS

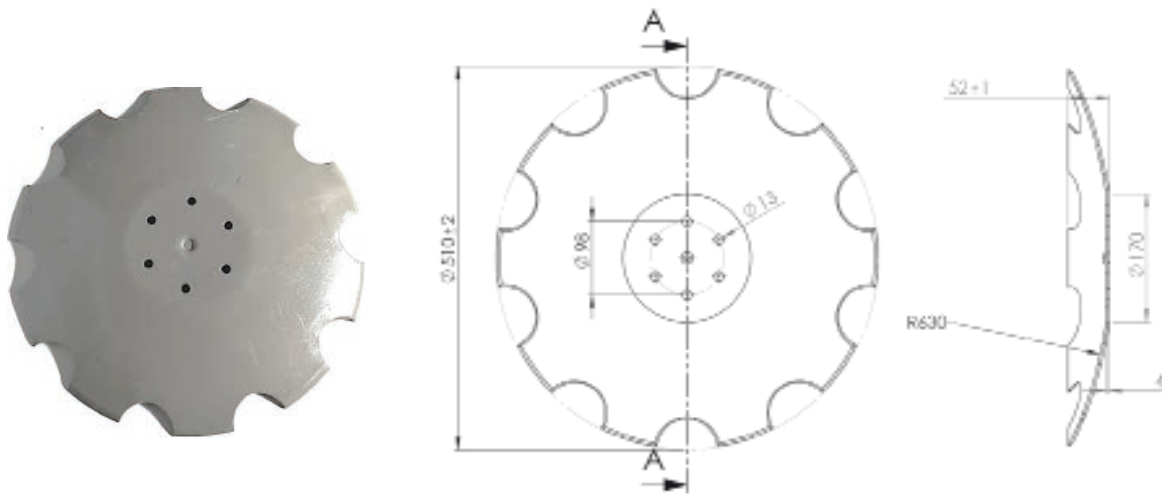

Art./Ref.	Diametro mm/ Diameter mm	Diam. Pollici/ Inch Diam.	Spessore mm/ Thickness mm	Concavità mm/ Concavity mm	Note/Notes
D510DBP6FS4R63A	510	20	4	52	DENTATO - N. 6 FORI Ø 13 SU CIRC. 98 SKF
D560DBPF6S4A	560	22	4	68	DENTATO - N. 6 FORI Ø 13 SU CIRC. 98 SKF

**DISCHI PER FRANGIZOLLE POLONIA - 5 FORI QUADRI INTERASSE 115**

DISQUES POLONIA - 5 TROUS CARRE' Ø 115  
 DISCS POLONIA - 5 SQUARE HOLES - DISTANCE Ø 115  
 GEWOELBTE SCHEIBEN NACH HERSTELLER  
 DISCOS DE ROTURADOR POLONIA - 5 AGUJEROS CUADROS DISTANCIA ENTRE EJES 115

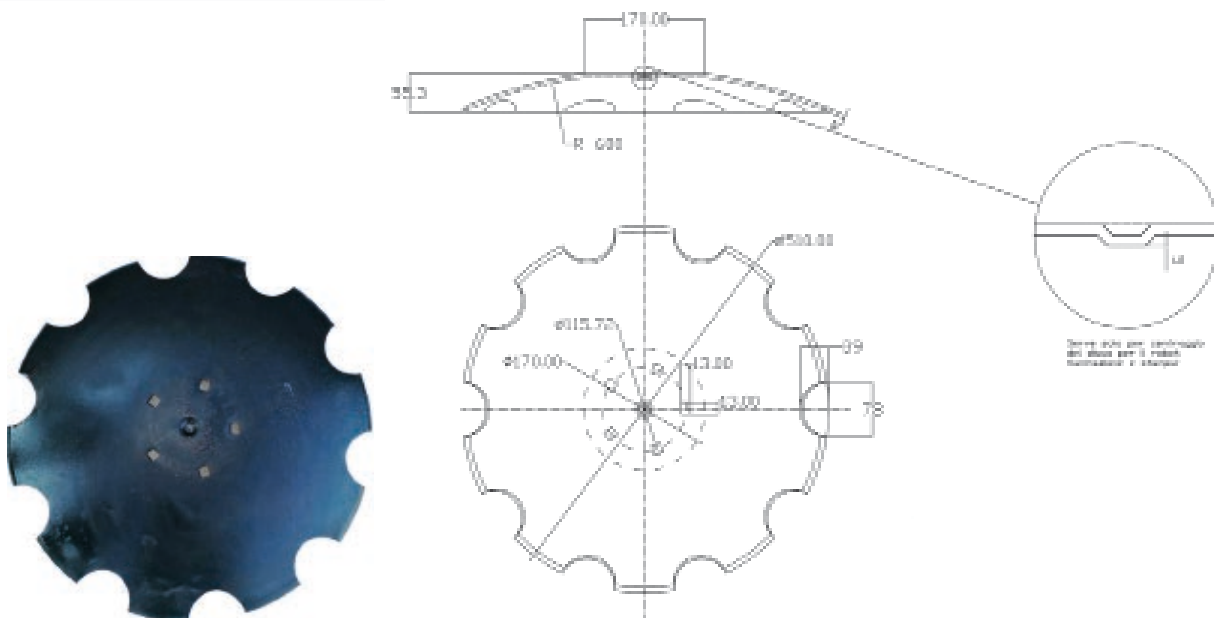

Art./Ref.	Diametro mm/ Diameter mm	Diam. Pollici/ Inch Diam.	Spessore mm/ Thickness mm	Concavità mm/ Concavity mm	Note/Notes
D510DBPF5QS4A	510	20	4	55	DENTATO - 5 FORI QUADRI 13 SU CIRC. 115,72
D560DBPF5QS4A	560	22	4	67.9	DENTATO - 5 FORI QUADRI 13 SU CIRC. 115,72
D610DBPF5QS5A	610	24	5	82.25	DENTATO - 5 FORI QUADRI 13 SU CIRC. 115,72

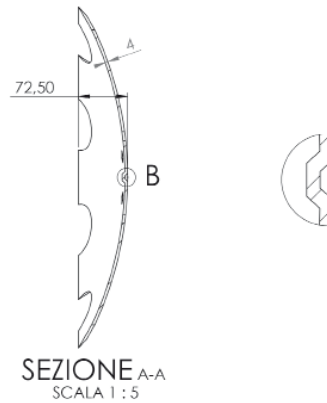
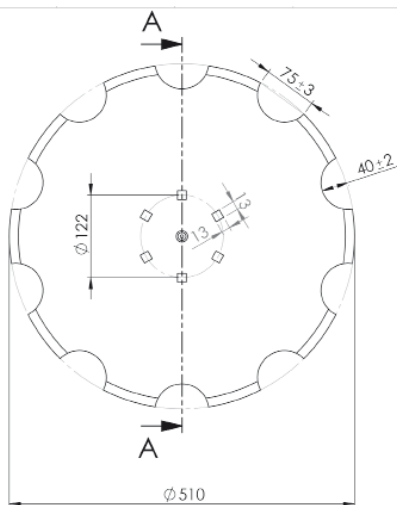
**DISCHI PER FRANGIZOLLE POLONIA - 6 FORI QUADRI INTERASSE 122**
*DISQUES POLONIA - 6 TROUS CARRE' Ø 122*
*DISCS POLONIA - 6 SQUARE HOLES - DISTANCE Ø 122*
*GEWOELBTE SCHEIBEN NACH HERSTELLER Ø 122*
*DISCOS DE ROTURADOR POLONIA - 5 AGUJEROS CUADROS DISTANCIA ENTRE Ø 122*

Art./Ref.	Diametro mm/ Diameter mm	Diam. Pollici/ Inch Diam.	Spessore mm/ Thickness mm	Concavità mm/ Concavity mm	Note/Notes
D510D6F13S4R02A	510	20	4	72.5	DENTATO - 6 FORI QUADRI 13 SU CIRC. 122
D560D6F13S4A	560	22	4	73.2	DENTATO - 6 FORI QUADRI 13 SU CIRC. 122
D560DBPF6QS4A	560	22	4	67.9	DENTATO - 6 FORI QUADRI 13 SU CIRC. 122
D610D6F13S5SA	610	24	5	89	DENTATO - 6 FORI QUADRI 13 SU CIRC. 122
D610DBPF6QS5A	610	24	5	78	DENTATO - 6 FORI QUADRI 13 SU CIRC. 122

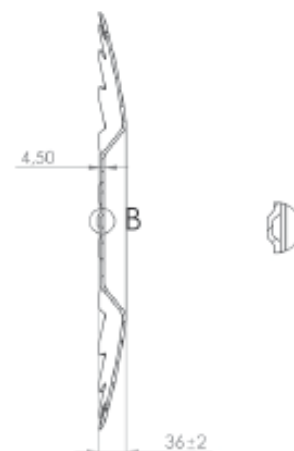
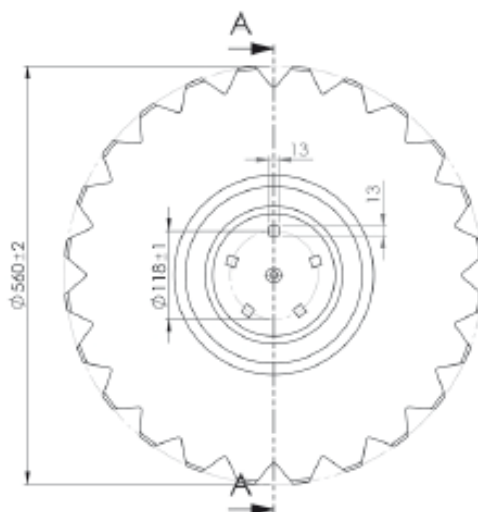
**DISCHI PER FRANGIZOLLE POLONIA - 6 FORI QUADRI INTERASSE 122**
*DISQUES POLONIA - 6 TROUS CARRE' Ø 122*
*DISCS POLONIA - 6 SQUARE HOLES - DISTANCE Ø 122*
*GEWOELBTE SCHEIBEN NACH HERSTELLER Ø 122*
*DISCOS DE ROTURADOR POLONIA - 5 AGUJEROS CUADROS DISTANCIA ENTRE Ø 122*

Art./Ref.	Diametro mm/ Diameter mm	Diam. Pollici/ Inch Diam.	Spessore mm/ Thickness mm	Concavità mm/ Concavity mm	Note/Notes
DINT560F5S45BA	560	22	4.5	36	DENTATO - 5 FORI QUADRI 13 SU CIRC. 118

**DISCHI PER ARATRO SUDAMERICA**

DISQUES DE CHARRUES POUR AMERIQUE DU SUD  
 PLOUGH DISCS SOUTH AMERICA  
 GEWOELBTE SCHEIBEN NACH HERSTELLER  
 DISCOS DE ARADO SUDAMÉRICA

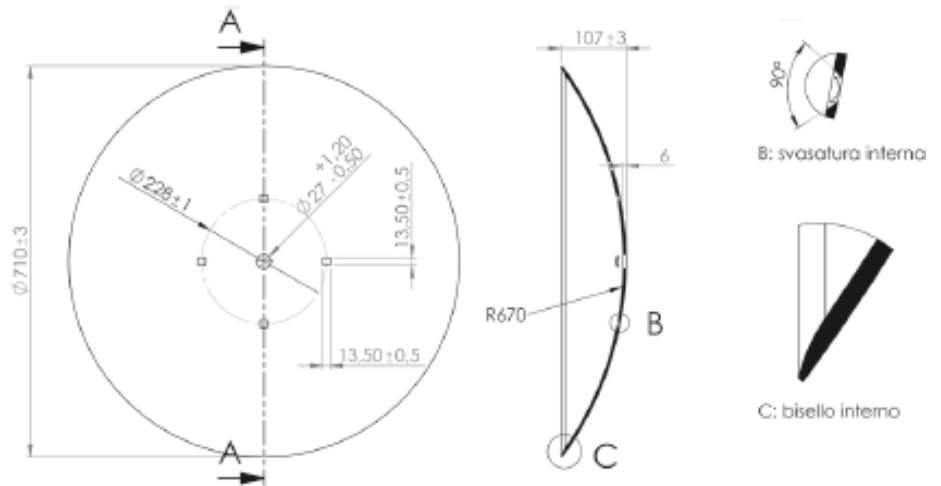
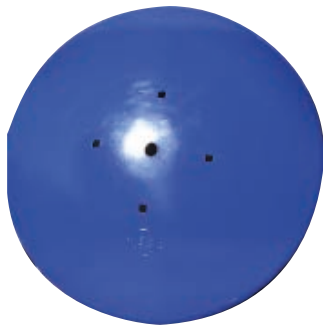

Art./Ref.	Diametro mm/ Diameter mm	Diam. Pollici/ Inch Diam.	Spessore mm/ Thickness mm	Foro mm/ Hole mm	Concavità mm/ Concavity mm	Note/Notes
D710LT27FQS4S6A	710	28	6	27	107	LISCIO - N. 4 FORI QUADRI 13,5 SU CIRC. 228 SVASATURA INTERNA

**DISCHI PER ARATRO SUDAMERICA**

DISQUES DE CHARRUES POUR AMERIQUE DU SUD  
 PLOUGH DISCS SOUTH AMERICA  
 GEWOELBTE SCHEIBEN NACH HERSTELLER  
 DISCOS DE ARADO SUDAMÉRICA

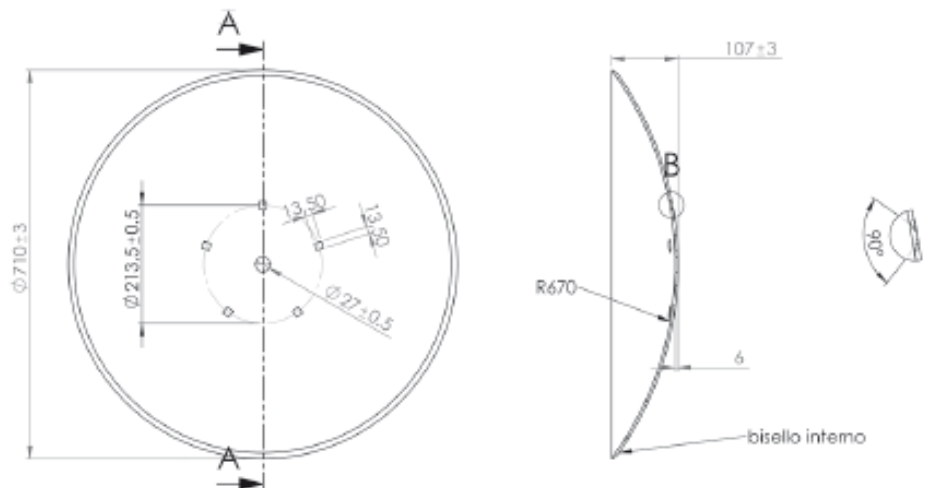
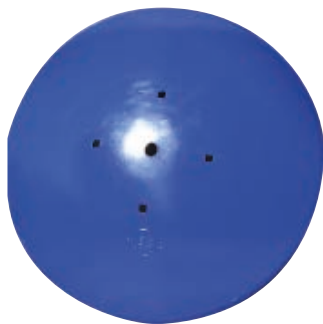

Art./Ref.	Diametro mm/ Diameter mm	Diam. Pollici/ Inch Diam.	Spessore mm/ Thickness mm	Foro mm/ Hole mm	Concavità mm/ Concavity mm	Note/Notes
D710LT27FQS5S6A	710	28	6	27	107	LISCIO - N. 5 FORI QUADRI 13,5 SU CIRC. 213,5 SVASATURA INTERNA

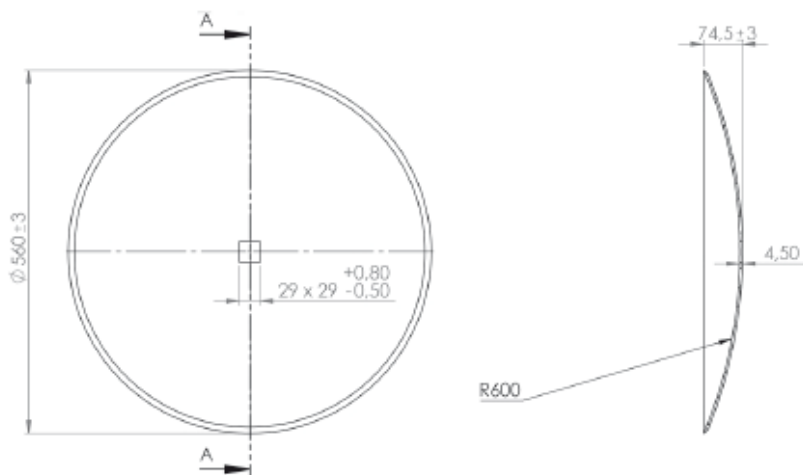
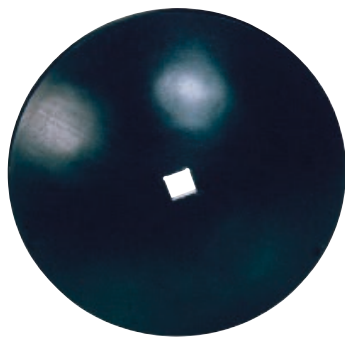
**DISCHI FRANGIZOLLE SUDAMERICA LISCI BOMBATI**
*DISQUES POUR AMERIQUE DU SUD LISSE CONCAVE*
*SMOOTH CONCAVE DISCS SOUTH AMERICA*
*GLATTE SCHEIBE*
*DISCOS DE GRADA SUDAMÉRICA LISOS ABOMBADOS*

Art./Ref.	Diametro mm/ Diameter mm	Diam. Pollici/ Inch Diam.	Spessore mm/ Thickness mm	Foro mm/Hole mm	Concavità mm/ Concavity mm
D560LQ29S45A	560	22	4.5	29	74.5
D610LQ29S6A	610	24	6	29	90

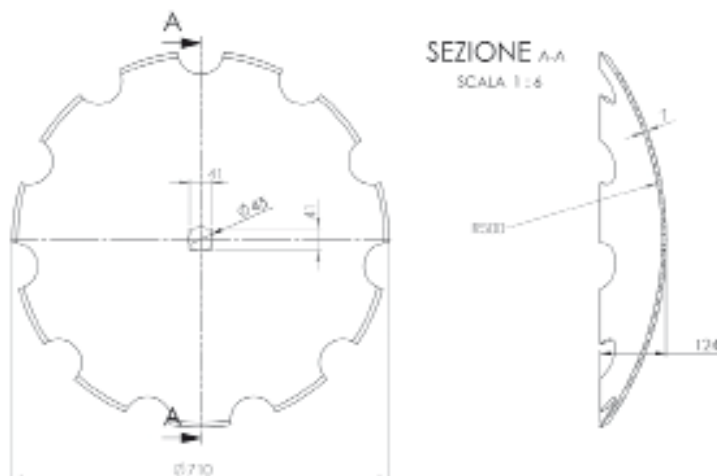
**DISCHI FRANGIZOLLE SUDAMERICA LISCI BOMBATI**
*DISQUES POUR AMERIQUE DU SUD LISSE CONCAVE*
*SMOOTH CONCAVE DISCS SOUTH AMERICA*
*SMOOTH CONCAVE DISCS SOUTH AMERICA*
*DISCOS DE GRADA SUDAMÉRICA LISOS ABOMBADOS*

Art./Ref.	Diametro mm/ Diameter mm	Diam. Pollici/ Inch Diam.	Spessore mm/ Thickness mm	Foro mm/Hole mm	Concavità mm/ Concavity mm	Note/Notes
D710DQT45S7A	710	28	7	41/45	124	DENTATO-FORO QUADRATO 41+TONDO ø 45
D710DQT45S8A	710	28	8	41/45	125	DENTATO-FORO QUADRATO 41+TONDO ø 45

**DISCHI FRANGIZOLLE SUDAMERICA DENTATI BOMBATI**

DISQUES POUR AMERIQUE DU SUD CRENELE CONCAVE  
 NOTCHED CONCAVE DISCS SOUTH AMERICA  
 GEWOELBTE SCHEIBEN NACH HERSTELLER  
 DISCOS DE GRADA SUDAMÉRICA DIENTES ABOMBADOS

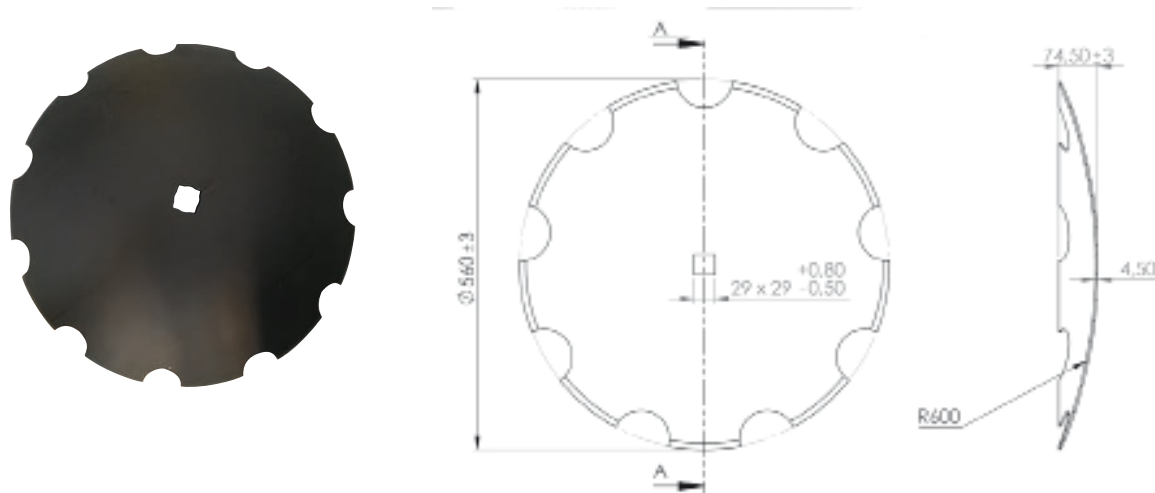

Art./Ref.	Diametro mm/Diameter mm	Diam. Pollici/Inch Diam.	Spessore mm/Thickness mm	Foro mm/Hole mm	Concavità mm/Concavity mm
D560DQ29S45A	560	22	4.5	29	74.5
D610DQ29S6A	610	24	6	29	90
D610DQ29S45A	610	24	4.5	29	88

**DISCHI FRANGIZOLLE SUDAMERICA FORO ROTONDO**

DISQUES POUR AMERIQUE DU SUD TROU ROND  
 DISCS WITH ROUND HOLE SOUTH AMERICA  
 GEWOELBTE SCHEIBEN NACH HERSTELLER  
 DISCOS DE GRADA SUDAMÉRICA AGUJERO REDONDO

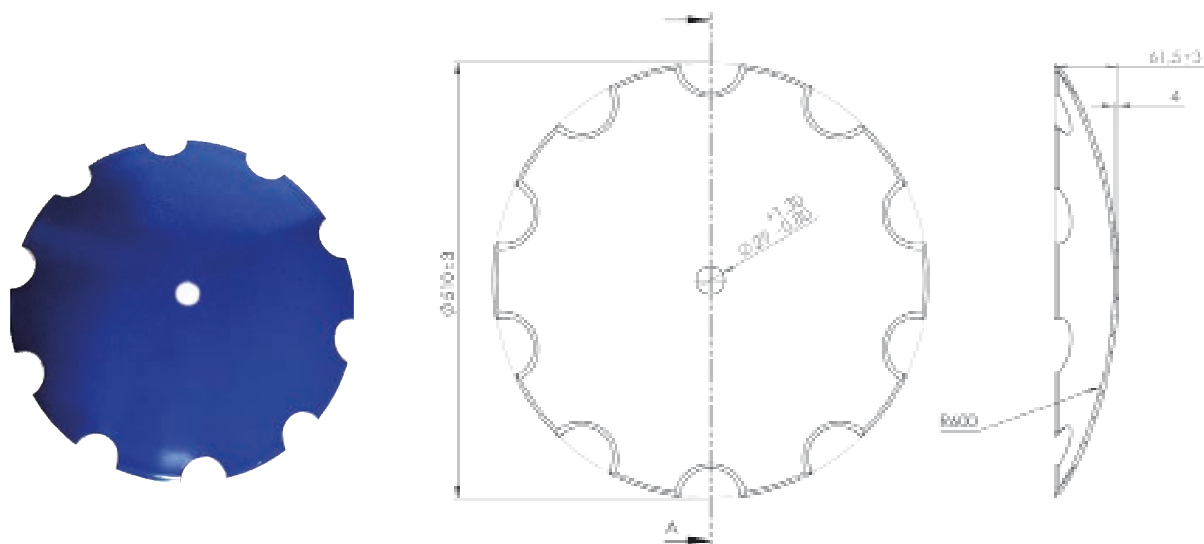

Art./Ref.	Diametro mm/ Diameter mm	Diam. Pollici/Inch Diam.	Spessore mm/ Thickness mm	Foro mm/Hole mm	Concavità mm/ Concavity mm	Peso Kg/Weight Kg
D510DT29S4A	510	20	4	29	61.5	5.800
D560DT29S45A	560	22	4.5	29	74	8.000
D560DT32S45A	560	22	4.5	32	74.5	8.000
D560DT32S45R67A	560	22	4.5	32	66	8.000
D660DT43S6R67A	660	26	6	43	93	15.700

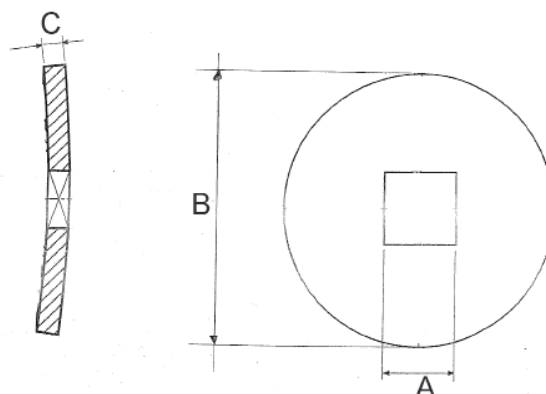
**FLANGE DI CHIUSURA PER ASSI FRANGIZOLLE**
*BRIDE DE FERMETURE POUX AXES BRISE-MOTTES*
*GRIPPING FLANGE FOR DISK HARROW AXLES*
*VERSCHLUSS-FLANSCH FÜR EGGENSCHLEIBEN-ACHSE*
*ARANDELA DE CIERRRE PARA BARRAS ROTURADOR*

**NOTE:** Tutti i prodotti presenti in tabella vengono forniti non verniciati.

**NOTES:** All products in the table are supplied unpainted

Art./Ref.	A mm	B mm	C mm	Note/Notes
SAR6115	26	135	10	Concava
SAR6116	26	115	10	Convessa
SAR6117	31	145	12	Concava
SAR6118	31	145	10	Convessa
SAR6117B	41	145	15	Concava
SAR6118B	41	145	15	Convessa

**DISTANZIALI PER FRANGIZOLLE FLR**
*ECARTEUR POUR BRISE MOTTES FLR*
*SPACERS FOR FLR DISK HARROW*
*DISTANZSTUECK*
*RIOSTRAS DE ROTURADOR FLR*
**NOTE:** Tutti i prodotti presenti in tabella vengono forniti non verniciati.

**NOTES:** All products in the table are supplied unpainted

Art./Ref.	Titolo Prodotto/Product title	A mm	B mm	C mm	D mm	E mm	F mm	L mm
CP1885	DISTANZIALE EDLXP	100	5	100	70	5	26	174
CP1885A	DISTANZIALE 4C4012	125	8	125	102	8	31	225.5

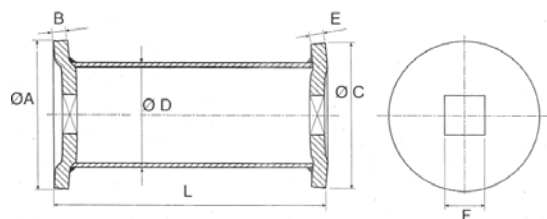
**DISTANZIALI PER FRANGIZOLLE**
*ECARTEUR POUR BRISE MOTTES*
*SPACERS FOR DISK HARROW*
*DISTANZSTUECK*
*RIOSTRAS DE ROTURADOR*
**NOTE:** Tutti i prodotti presenti in tabella vengono forniti non verniciati.

**NOTES:** All products in the table are supplied unpainted

Art./Ref.	Titolo Prodotto/Product title	A mm	B mm	C mm	D mm	E mm	F mm	L mm
CP1886	DISTANZIALE EVPT	125	6	125	89	6	26	221
CP1887	DISTANZIALE 4C4010	125	8	125	102	8	26	225.5
CP1888	DISTANZIALE 5C4012	145	10	145	114	10	31	225.5
CP1889C	DISTANZIALE 6C4012 Q.33	145	10	145	114	10	33	225.5
CP1889	DISTANZIALE 6C4012	145	10	145	114	10	41	225.5
CP1890	DISTANZIALE 7C4012	180	12	155	127	12	41	275

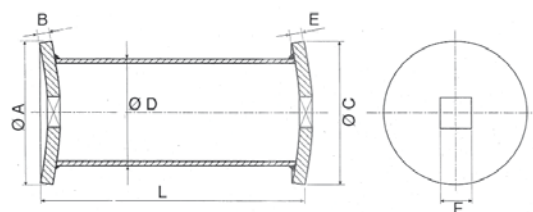

## SEMIDISTANZIALI PER FRANGIZOLLE

SEMI-ECARTEUR POUR BRISE MOTTES

DEMI-SPACERS FOR DISK HARROW

Distanzstueck

SEMI RIOSTRAS DE ROTURADOR

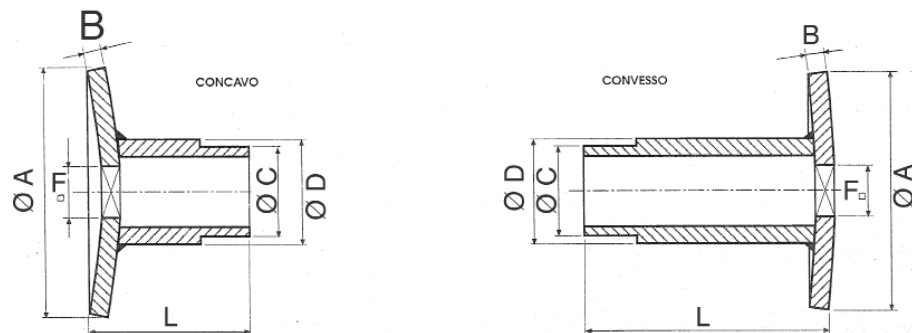

NOTE: Tutti i prodotti presenti in tabella vengono forniti non verniciati.

NOTES: All products in the table are supplied unpainted.

Art./Ref.	Titolo Prodotto/Product title	A mm	B mm	C mm	D mm	F mm	L mm	Tipo/Type
CP1892A	SEMIDISTANZIALE CORTO EDLXP/CC	100	8	45	54	26	62	CONCAVO
CP1892B	SEMIDISTANZIALE LUNGO EDLXP/CC	100	8	45	54	26	112	CONVESSO
CP1894A	SEMIDISTANZIALE CORTO 4C4022	135	10	45	54	26	80	CONCAVO
CP1894B	SEMIDISTANZIALE LUNGO 4C4032	115	10	45	54	26	136	CONVESSO
CP1894C	SEMIDISTANZIALE CORTO 4C4020	135	10	45	54	26	100	CONCAVO
CP1894D	SEMIDISTANZIALE LUNGO 4C4030	115	10	45	54	26	116	CONVESSO
CP1895A	SEMIDISTANZIALE CORTO 5C4022	145	12	55	63	31	82	CONCAVO
CP1895B	SEMIDISTANZIALE LUNGO 5C4032	145	12	55	63	31	139	CONVESSO
CP1895C	SEMIDISTANZIALE CORTO 5C4022 Q 33	145	12	55	63	33	82	CONCAVO
CP1895D	SEMIDISTANZIALE LUNGO 5C4032 Q 33	145	12	55	63	33	139	CONVESSO
CP1896A	SEMIDISTANZIALE CORTO 6C4020	145	12	60	70	33	100	CONCAVO
CP1896B	SEMIDISTANZIALE LUNGO 6C4030	145	12	60	70	33	116.5	CONVESSO
CP1896C	SEMIDISTANZIALE CORTO 6C4023	155	12	60	70	31	100	CONCAVO
CP1896D	SEMIDISTANZIALE LUNGO 6C4033	145	12	60	70	31	116.5	CONVESSO

## SEMIDISTANZIALI PER FRANGIZOLLE A CANNOCCHIALE

SEMI-ECARTEUR POUR BRISE MOTTES A LONGUE-VUE

DEMI-SPACERS FOR SPYGLASS DISK HARROW

Distanzstueck

SEMI RIOSTRAS DE ROTURADOR CATALEJO

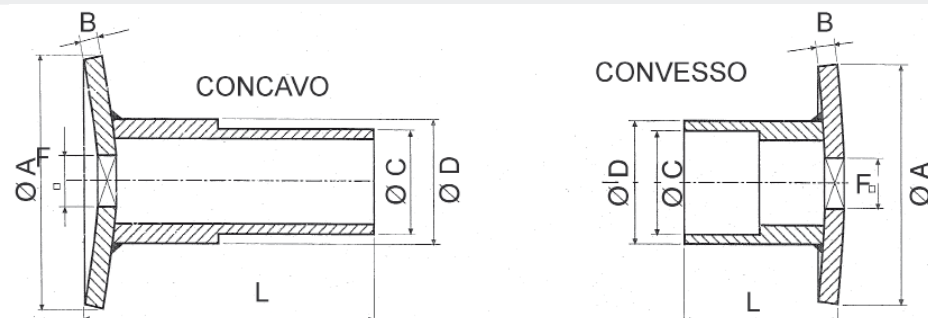

NOTE: Tutti i prodotti presenti in tabella vengono forniti non verniciati.

NOTES: All products in the table are supplied unpainted.

Art./Ref.	Titolo Prodotto/Product title	A mm	B mm	C mm	D mm	F mm	L mm	Tipo/Type
CP1887A	SEMIDISTANZIALE LUNGO EVPT/CC	135	10	45	54	26	196	CONCAVO
CP1887B	SEMIDISTANZIALE CORTO EVPT/CV	115	10	45	57	26	98	CONVESSO
CP1888A	SEMIDISTANZIALE LUNGO 5C4023	155	12	55	63	31	150	CONCAVO
CP1888B	SEMIDISTANZIALE CORTO 5C4033	145	12	55	63	31	114	CONVESSO
CP1889D	SEMIDISTANZIALE LUNGO 6C4023	135	12	60	70	31	193	CONCAVO
CP1889E	SEMIDISTANZIALE CORTO 6C4033	135	12	60	70	31	94	CONVESSO
CP1889A	SEMIDISTANZIALE LUNGO 7C4023	155	12	70	82.5	41	137	CONCAVO
CP1889B	SEMIDISTANZIALE CORTO 7C4033	145	12	70	82.5	41	118.5	CONVESSO

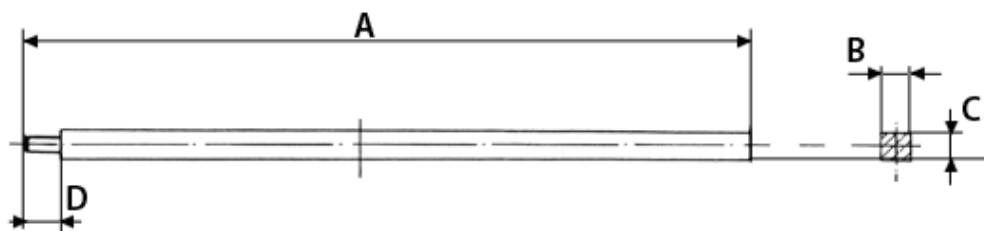

**ASSE PORTA DISCHI IN ACCIAIO PER FRANGIZOLLE COMPLETO DI DADO E FLANGE DI CHIUSURA**
*AXE PORTE DISQUES EN ACIER POUR BRISE-MOTTES COMPLET DE ECROU ET BRIDE DE FERMETURE*
*AXLE STEEL DISK HOLDER FOR DISK HARROW WITH GRIPPING NUT AND FLANGE*
*EGGENSCHEIBEN-ACHSE KOMPLETT MIT MUTTER UND FLANSCH*
*BARRA PORTADISCOS EN ACERO PARA ROTURADOR / CON DADO Y ARANDELA DE CIERRE*

**NOTE:** Tutti i prodotti presenti in tabella vengono forniti non verniciati.

**NOTES:** All products in the table are supplied unpainted

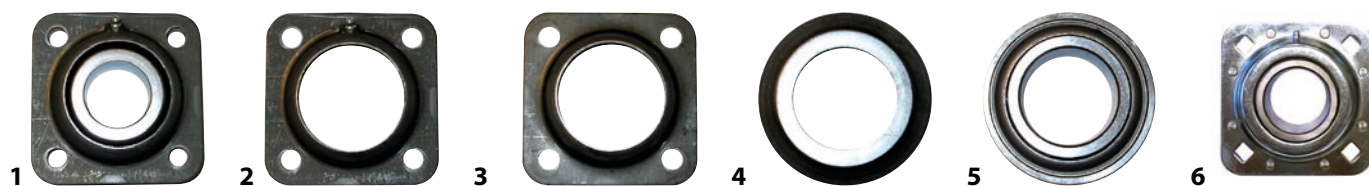
Art./Ref.	A mm	B mm	C mm	D mm	Note/Notes
SAR6110A	1008	25	25	60	filetto M 24
SAR6110	1870	25	25	60	filetto M 24
SAR6111	2025	25	25	60	filetto M 24
SAR6111A	2370	25	25	60	filetto M 24
SAR6112	1008	30	30	60	filetto M 27
SAR6112A	1870	30	30	60	filetto M 27
SAR6113	2140	30	30	60	filetto M 27
SAR6114	2370	30	30	60	filetto M 27
SAR6113A	2450	30	30	60	filetto M 27
SAR6114E	2000	32	32	60	filetto M 27
SAR6114C	2000	40	40	60	filetto M 30/

**SUPPORTI CUSCINETTI PER FRANGIZOLLE**
*SUPPORTS PALIERS POUR BRISE-MOTTES*
*BEARING SUPPORTS FOR DISK ARROW*
*KUGELLAGER FUER EGGENSCHIEBEN*
*SOPORTES COJINETES PARA ROTURADOR*

Art./Ref.	Pos.	Titolo Prodotto/Product title	Foro mm/Hole mm	Note/Notes
SAR6102	1	SUPPORTO COMPLETO	55	Interasse fori 98 mm
SAR6107	3	FLANGIA PER CUSCINETTO DA 55 MM		
SAR61071	2	FLANGIA PER CUSCINETTO DA 55 MM CON INGRASSATORE		
SAR6105	4	PARAPOLVERE PER CUSCINETTO DA 55 MM		
SAR6103	5	CUSCINETTO DA 55 MM		
SAR6100E	6	SUPPORTO FRANGIZOLLE ASSEMBLATO E RIVETTATO 45 MM	45	Interasse fori 85 mm
SAR6102E	6	SUPPORTO FRANGIZOLLE ASSEMBLATO E RIVETTATO 55 MM	55	Interasse fori 98 mm

**MONTANTE PER SUPPORTO CUSCINETTO PER FRANGIZOLLE**

MONTANT POUR SUPPORT POUR BRISE-MOTTES

MOUNTING FOR DISK HARROW BEARING

HALTER FUER EGGENSCHIEBEN-KUGELLAGER

MONTANTE PARA SOPORTE COJINETE DE ROTURADOR



**NOTE:** Tutti i prodotti presenti in tabella vengono forniti non verniciati.

**NOTES:** All products in the table are supplied unpainted.

Art./Ref.	Titolo Prodotto/Product title	Note/Notes
<b>SAR6108</b>	MONTANTE PER CUSCINETTO/MONTANTE X CUSCINETTO Ø 45	Per cuscinetto da 45 mm
<b>SAR6109</b>	MONTANTE PER CUSCINETTO/MONTANTE X CUSCINETTO Ø 55	Per cuscinetto da 55 mm

**RASCHIETTO PER FRANGIZOLLE**

RACLETTES POUR BRISEURS

SCRAPER FOR DISK HARROW

SCHABEISEN FUER EGGENSCHIEBE

RASCADOR DE ROTURADOR

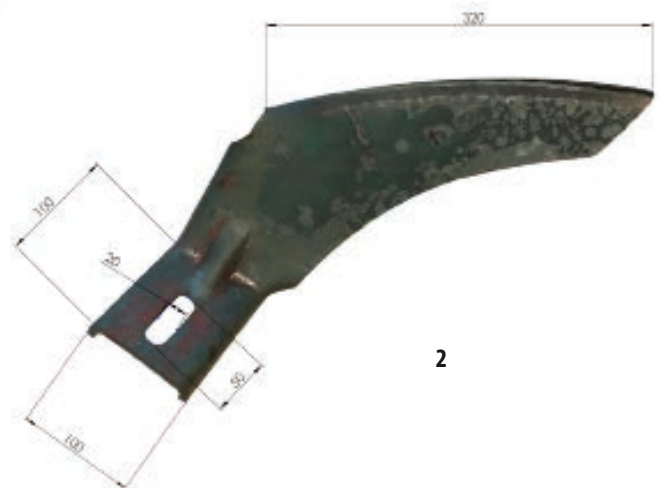
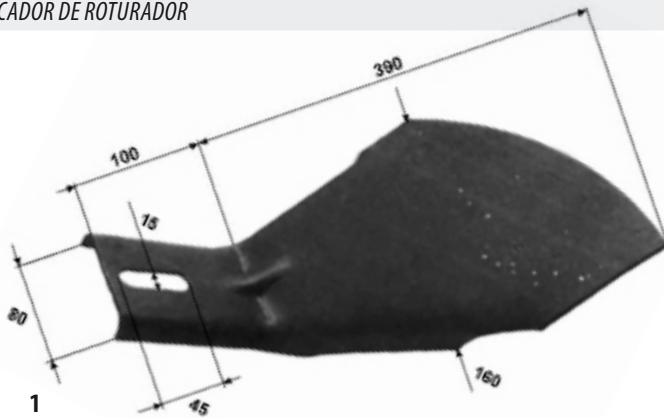

**NOTE:** Modello in figura DX. Tutti i prodotti presenti in tabella vengono forniti non verniciati.

**NOTES:** Model figure right. All products in the table are supplied unpainted

Art./Ref.	Titolo Prodotto/Product title	Spessore mm/Thickness mm	Tipo/Type
<b>CP1970</b>	RASCHIETTO PER FRANGIZOLLE DX	6 mm	1
<b>CP1970A</b>	RASCHIETTO PER FRANGIZOLLE SX	6 mm	1
<b>CP1970B</b>	RASCHIETTO PER FRANGIZOLLE DX	8 mm	2
<b>CP1970C</b>	RASCHIETTO PER FRANGIZOLLE SX	8 mm	2

**RASCHIETTO ADATTABILE A FRANGIZOLLE NARDI**

RACLETTES ADAPTABLE POUR BRISEUR NARDI

SCRAPERER SUITABLE NARDI DISK HARROW

SCHABEISEN PASSEND ZU EGGENSCHIEBEN NARDI

RASCADOR ADAPTABLE DE ROTURADOR NARDI

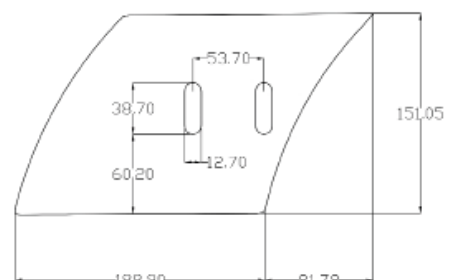

SPESORE 6MM

Art./Ref.	Titolo Prodotto	Note
<b>CP1971</b>	RASCHIETTO PER FRANGIZOLLE	Adattabile Nardi

**RASCHIETTO ADATTABILE A MASCHIO**

RACLETTE ADAPTABLE POUR MASCHIO  
 SCRAPERER SUITABLE MASCHIO  
 SCHABEISEN PASSEND ZU MASCHIO  
 RASCADOR ADAPTABLE MASCHIO

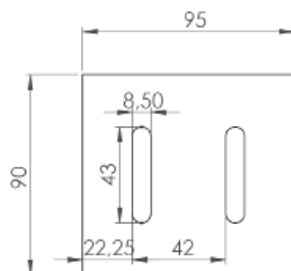
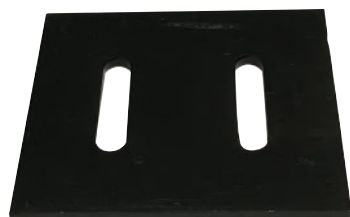

Art./Ref.	Titolo Prodotto/Product title	Spessore mm/Thickness mm	Peso Kg/Weight Kg	Brand	Rif. Orig./Orig. Ref.
<b>CP1976</b>	RASCHIETTO	4 mm	0,25	MASCHIO	27100539, 36100499, M27100539R

**SUPPORTI CUSCINETTI ADATTABILI A FRANGIZZOLLE NARDI**

SUPPORTS PALIERS ADAPTABLES AUX BRISE-MOTTES NARDI  
 ADAPTABLE BEARING SUPPORTS FOR NARDI DISK HARROW  
 KUGELLAGER FUER EGGENSCHIEBEN NARDI  
 SOPORTES COJINETES ADAPTABLES PARA ROTURADOR NARDI

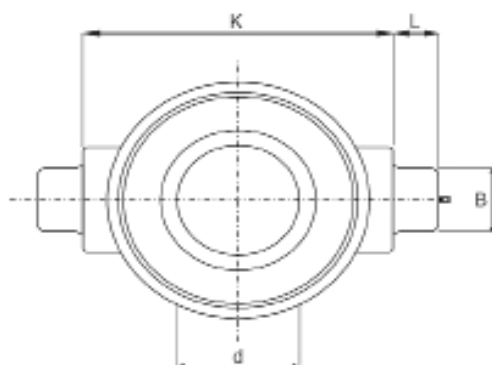

Art./Ref.	Titolo Prodotto/Product title	d mm	L mm	B mm	K mm	Peso Kg/Weight Kg	Foro mm/Hole mm
<b>SAR6098</b>	CUSCINETTO COMPLETO	45	16,5	26	114	2	
<b>SAR6099</b>	CUSCINETTO COMPLETO	60	21	32	132	3,1	
<b>SAR6099B</b>	CUSCINETTO COMPLETO	70	21	40	150	4,5	
<b>SAR6084</b>	CUSCINETTO NUDO						45
<b>SAR6087</b>	CUSCINETTO NUDO						60
<b>SAR6088</b>	PARAPOLVERE						45
<b>SAR6089</b>	PARAPOLVERE						60

**MOZZO SKF AGRI HUB CON FLANGIA A BASE PIANA PER ELEMENTI FRANGIZOLLE**

MOYEU DE SKF AGRI HUB À BASE PLATE AVEC BRIDE POUR ÉLÉMENTS HERSES

FLAT-BASED SKF AGRI HUB WITH FLANGE FOR HARROW ELEMENTS

HALTERUNG SKF AGRI HUB MIT FLANSCH FUER SCHEIBENEGGEN

EJE SKF AGRI HUB CON BRIDA FONDO PLANO POR ELEMENTOS ROMPIPLACAS

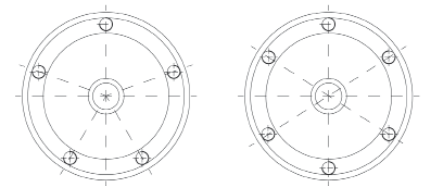
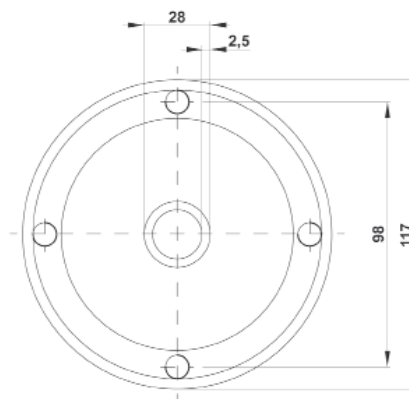
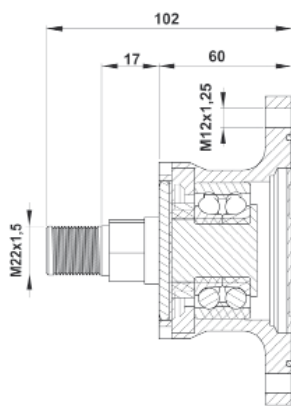
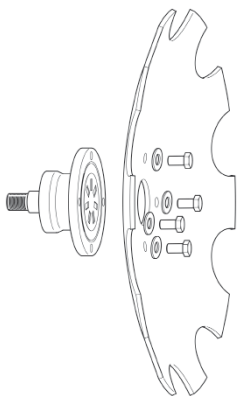

**NOTE:** Il SKF Agri hub è un'unità cuscinetto completa, ingrassata e lubrificata a vita. Condizioni di applicazione tipiche: -Velocità trattore: 5-20 km/h -Diametro disco: 300-610 mm -Temperatura: da -20 a +50 °C. Condizioni di lavoro difficili: paglia, fibre vegetali, pietre, fertilizzanti, fango, polvere, acqua, neve.

**NOTES:** The SKF Agri hub is a fully integrated hub bearing system, greased and sealed for the life of the unit. Typical application conditions: -Tractor Speed: 5-20 km/h -Disc Diameter: 300-610 mm -Temperature: -20 to +50 °C. -Harsch working conditions: straw, strings, stones, fertilizers, mud, dust, water, snow.

Art./Ref.	Titolo Prodotto/Product title	Foro mm/Hole mm	Note/Notes
CP6624	MOZZO FRANGIZOLLE 4 FORI SKF	4xM12x1,25	Diametro perno di fissaggio mm 28
CP6625	MOZZO FRANGIZOLLE 5 FORI SKF	5xM12x1,25	Diametro perno di fissaggio mm 28
CP6626	MOZZO FRANGIZOLLE 6 FORI SKF	6xM12x1,25	Diametro perno di fissaggio mm 28

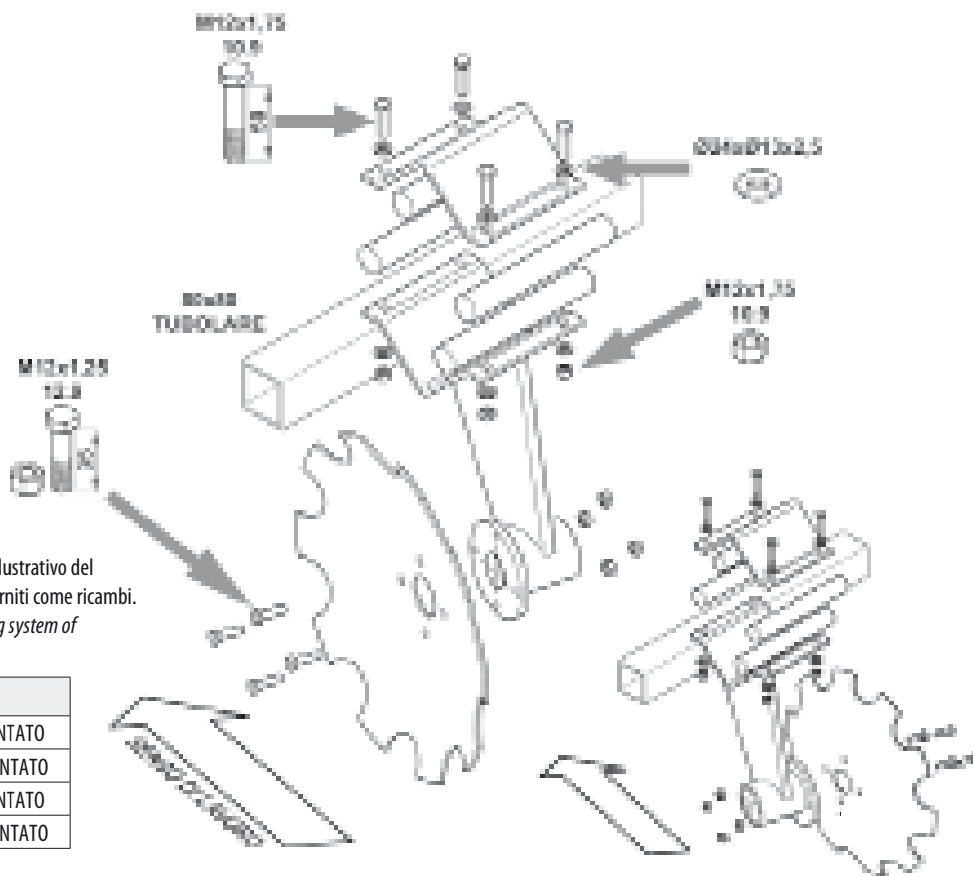
**GRUPPO MOZZO COMPLETO PER ERPICE A DISCHI INDIPENDENTI DA 460 E 510 TUBULARE 80X80**
*GROUPE MOYEU COMPLET POUR HERSE A DISQUES INDIPENDENTS DE 460 ET 510 TUBULAIRE 80 X 80*
*COMPLETE HUB SET FOR INDIPENDENT DISC HARROW OF 460 AND 510 TUBULAR 80X80*
*NABENGRUPPE KOMPLETT FUER EGGENSCHIEBEN VON 460 BIS 510 ROHR 80X80*
*GRUPO COMPLETO CORONA CENTRAL PARA GRADA CON DISCOS INDEPENDIENTES DE 460 Y 510 - TUBULAR 80X80*

**NOTE:** Le varie bullonerie in figura sono presenti solo a scopo illustrativo del sistema di montaggio del supporto completo e non vengono forniti come ricambi.

**NOTES:** Bolts and tubular in figure are only to illustrate the fitting system of The complete support and they are not supplied as spare parts.

Art./Ref.	Titolo Prodotto/Product title
CP5851	SUPPORTO ANTERIORE CON DISCO DA 460 DENTATO
CP5853	SUPPORTO POSTERIORE CON DISCO DA 460 DENTATO
CP5855	SUPPORTO ANTERIORE CON DISCO DA 510 DENTATO
CP5857	SUPPORTO POSTERIORE CON DISCO DA 510 DENTATO

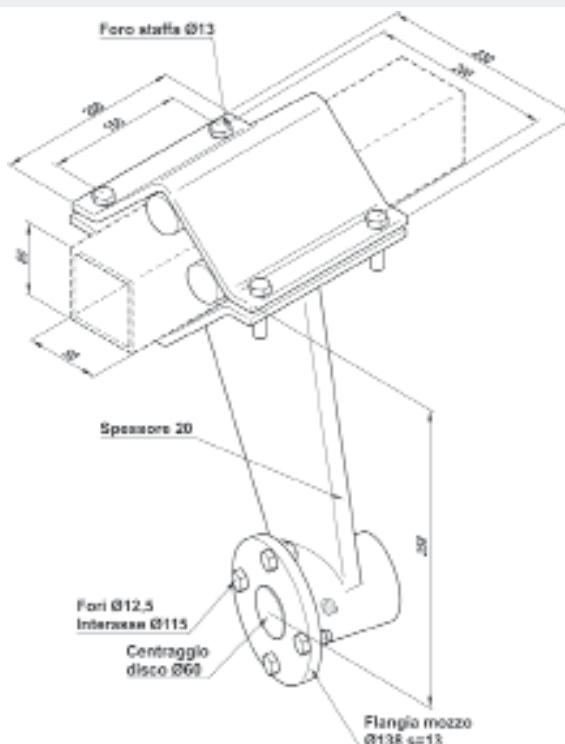
**GRUPPO MOZZO COMPLETO PER ERPICE A DISCHI INDIPENDENTI DA 460 E 510 TUBULARE 80X80 SENZA DISCO**
*GROUPE MOYEU COMPLET POUR HERSE A DISQUES INDIPENDENTS DE 460 ET 510 TUBULAIRE 80 X 80 SANS DISQUE*
*COMPLETE HUB SET FOR INDIPENDENT DISC HARROW OF 460 AND 510 TUBULAR 80X80 WITHOUT DISC*
*NABENGRUPPE KOMPLETT FUER EGGENSCHIEBEN VON 460 BIS 510 ROHR 80X80 OHNE SHEIBE*
*GRUPO COMPLETO CORONA CENTRAL PARA GRADA CON DISCOS INDEPENDIENTES DE 460 Y 510 - TUBULAR 80X80 SIN DISCO*

Art./Ref.	Titolo Prodotto/Product title
CP6049	SUPPORTO COMPLETO ANTERIORE SENZA DISCO 460-510
CP6050	SUPPORTO COMPLETO POSTERIORE SENZA DISCO 460-510

**ELEMENTO FRANGIZOLE ANTERIORE E POSTERIORE PER DISCO DA 460 E 510**

ELEMENT BRISE-MOTTES ANTERIEUR ET POSTERIEUR POUR DISQUE DE 460 ET 510

FRONT AND REAR DISK HARROW FOR DISK OF 460 AND 510

VORDER- UND HINTER-EGGENSCHEIBE FUER SCHEIBE AB 460 BIS 510

ELEMENTO ROTURADOR ANTERIOR Y POSTERIOR PARA DISCO DE 460 Y 510

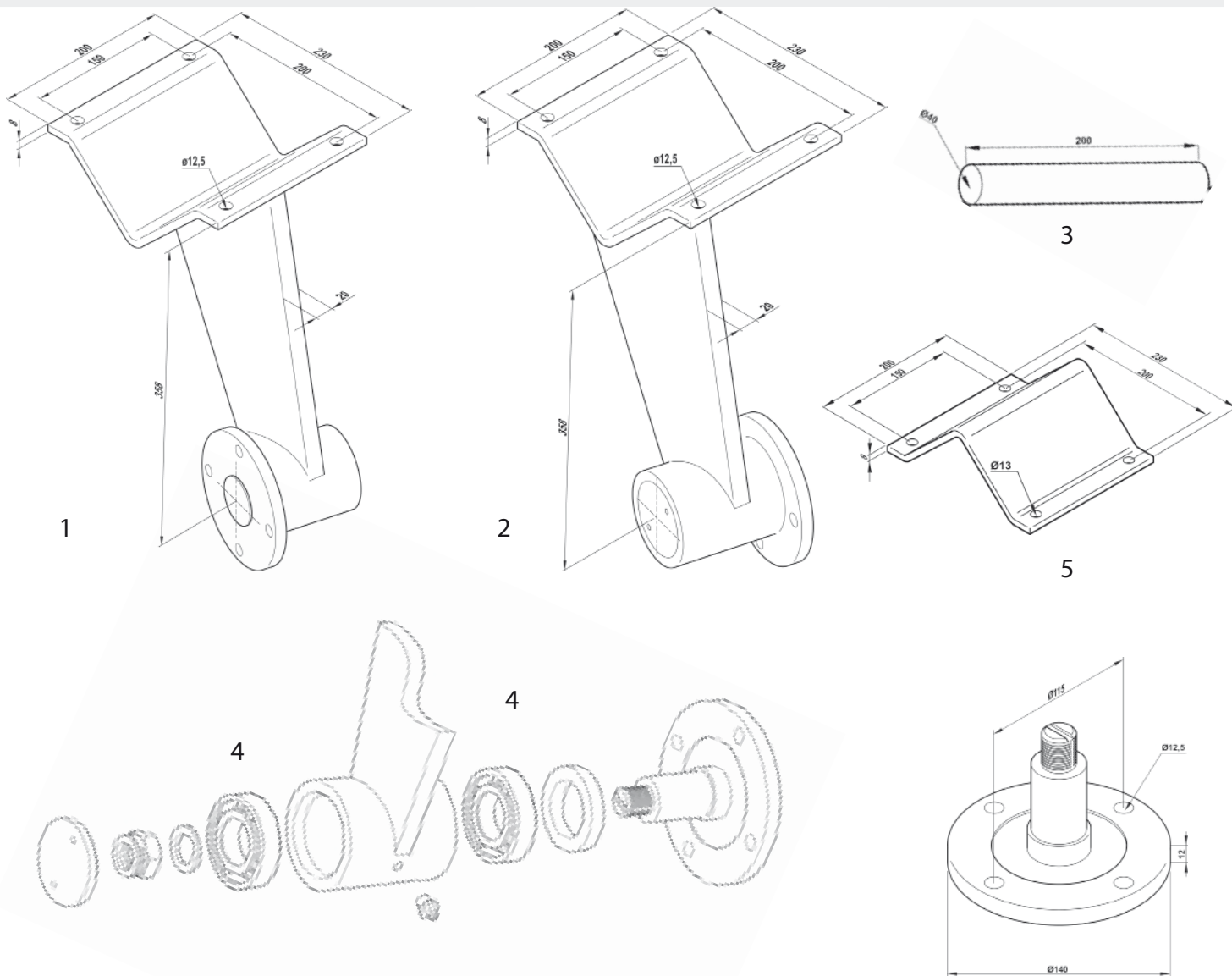

Art./Ref.	Pos.	Titolo Prodotto/Product title	Peso Kg/Weight Kg
CP5470	1	SUPPORTO DISCO ANTERIORE	12.5
CP5470S	2	SUPPORTO DISCO POSTERIORE	12.5
CP5653A	3	SOSPENSIONE ELASTICA	0,25
SMI120848	5	STAFFA SUPERIORE SUPPORTO	4
SMI121391	4	CUSCINETTO A RULLI	0.22
CP5509	6	FLANGIA MOZZO PER DISCO DA 460 E 510	2

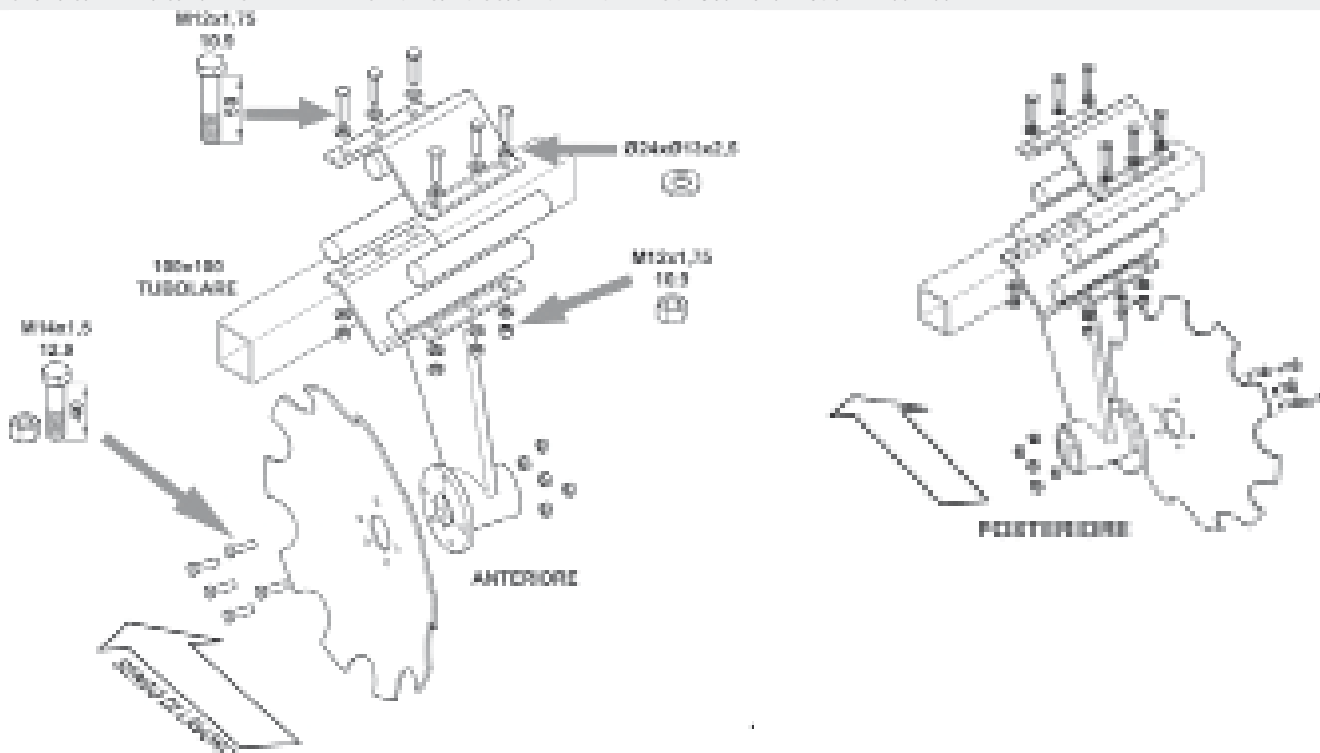

**GRUPPO MOZZO COMPLETO SALDATO PER ERPICE A DISCHI INDIPENDENTI DA 560 E 610 TUBOLARE 100X100**
*GRUPE MOYEU COMPLET POUR HERSE A DISQUES INDIPENDENTS DE 560 ET 610 TUBULAIRE 100 X 100*
*COMPLETE HUB SET FOR INDIPENDENT DISC HARROW OF 560 AND 610 TUBULAR 100X100*
*NABENGRUPPE KOMPLETT FUER EGGENSCHIEBEN VON 560 BIS 610 ROHR 100X100*
*GRUPO COMPLETO CORONA CENTRAL PARA GRADA CON DISCOS INDEPENDIENTES DE 560 Y 610 - TUBOLAR 100X100*

**NOTE:** Le varie bullonerie in figura sono presenti solo a scopo illustrativo del sistema di montaggio del supporto completo e non vengono forniti come ricambi.

**NOTES:** *complet et ils ne sont pas fournis a' rechange.nuts/ bolts and tubular in figure are only to illustrate the fitting system of the complete support and they are not supplied as spare parts*

Art./Ref.	Titolo Prodotto
<b>CP5859</b>	SUPPORTO ANTERIORE CON DISCO DA 560 DENTATO
<b>CP5861</b>	SUPPORTO POSTERIORE CON DISCO DA 560 DENTATO
<b>CP5863</b>	SUPPORTO ANTERIORE CON DISCO DA 610 DENTATO
<b>CP5865</b>	SUPPORTO POSTERIORE CON DISCO DA 610 DENTATO

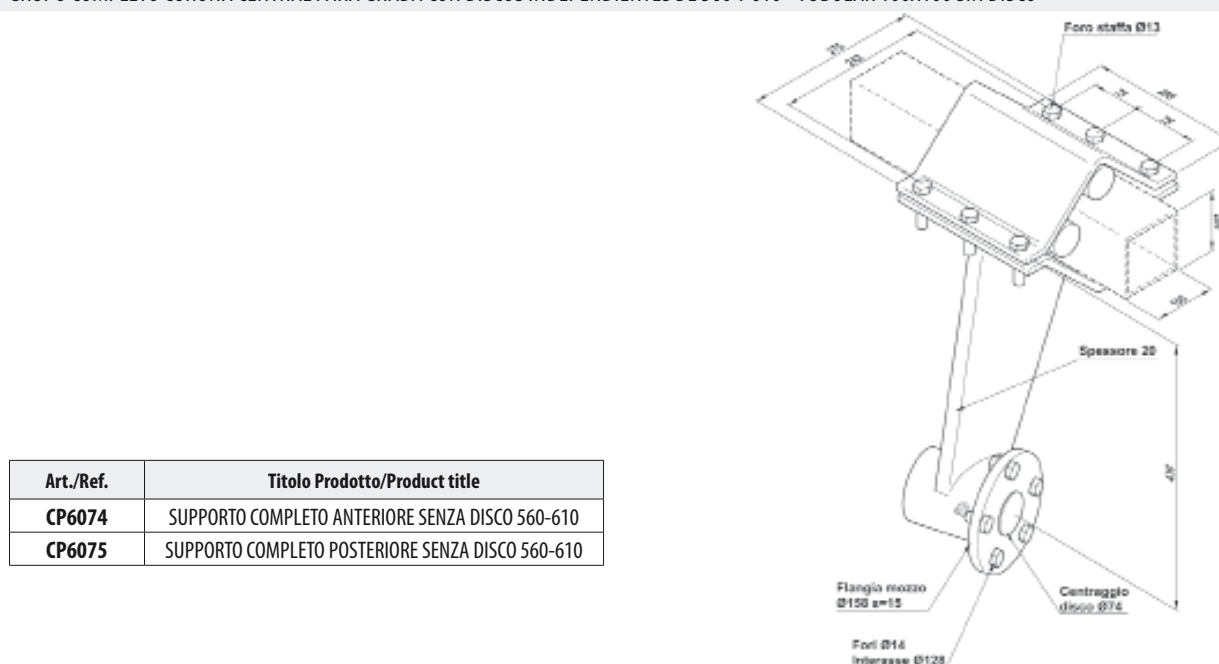
**GRUPPO MOZZO COMPLETO PER ERPICE A DISCHI INDIPENDENTI DA 560 E 610 TUBOLARE 100X100 SENZA DISCO**
*GRUPE MOYEU COMPLET POUR HERSE A DISQUES INDIPENDENTS DE 560 ET 610 TUBULAIRE 100 X 100 SANS DISQUE*
*COMPLETE HUB SET FOR INDIPENDENT DISC HARROW OF 560 AND 610 TUBULAR 100X100 WITHOUT DISC*
*NABENGRUPPE KOMPLETT FUER EGGENSCHIEBEN VON 560 BIS 610 ROHR 100X100 OHNE SHEIBE*
*GRUPO COMPLETO CORONA CENTRAL PARA GRADA CON DISCOS INDEPENDIENTES DE 560 Y 610 - TUBOLAR 100X100 SIN DISCO*

Art./Ref.	Titolo Prodotto/Product title
<b>CP6074</b>	SUPPORTO COMPLETO ANTERIORE SENZA DISCO 560-610
<b>CP6075</b>	SUPPORTO COMPLETO POSTERIORE SENZA DISCO 560-610



**ELEMENTO FRANGIZOLE ANTERIORE E POSTERIORE PER DISCO DA 560 E 610**

ELEMENT BRISE-MOTTES ANTERIEUR ET POSTERIEUR POUR DISQUE DE 560 ET 610

FRONT AND REAR DISK HARROW FOR DISC OF 560 AND 610

VORDER- UND HINTER-EGGENSCHEIBE FUER SCHEIBEN AB 560 UND 610

ELEMENTO ROTURADOR ANTERIOR Y POSTERIOR PARA DISCO DE 560 Y 610

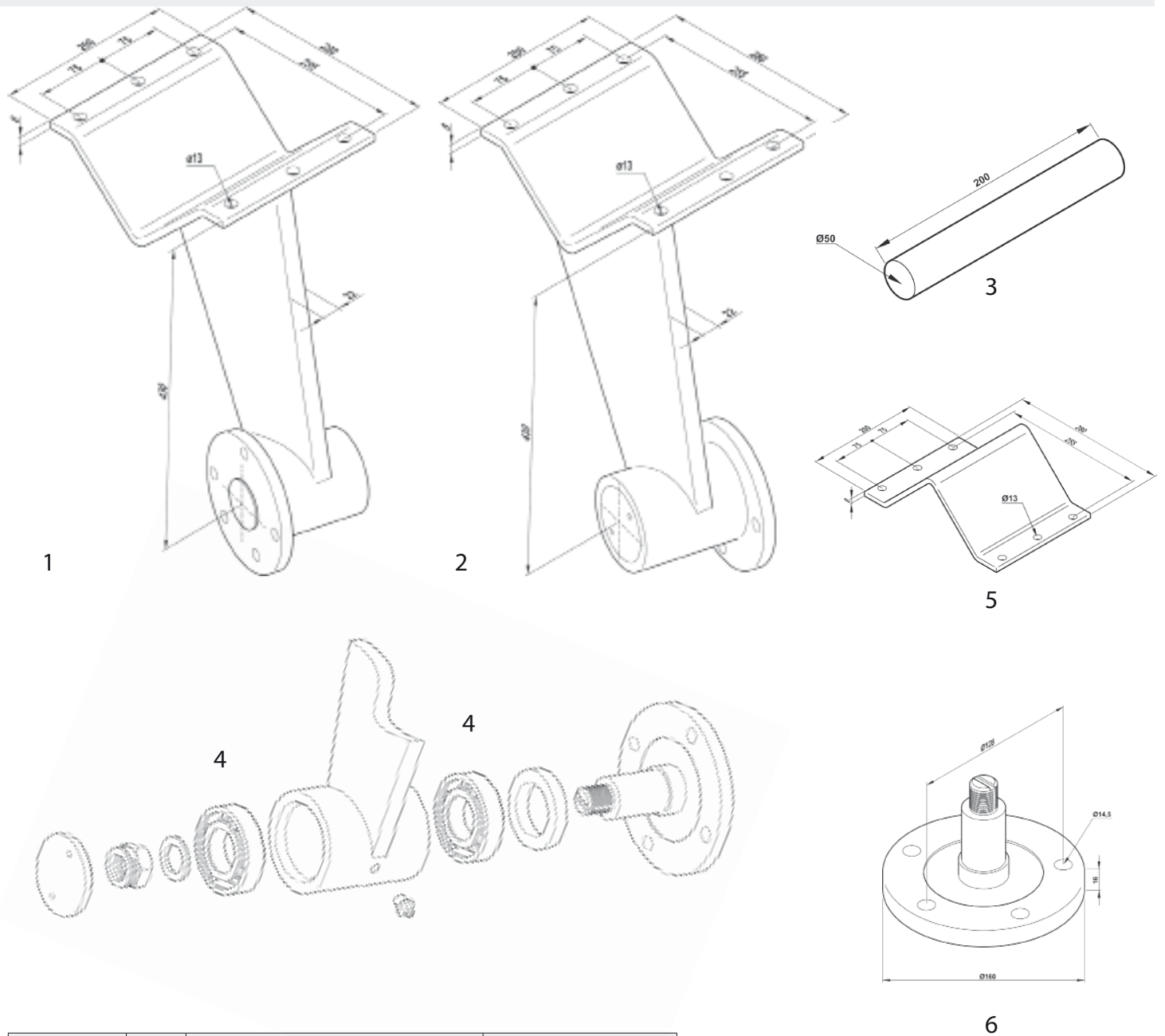

Art./Ref.	Pos.	Titolo Prodotto/Product title	Peso Kg/Weight Kg
CP5469	1	SUPPORTO DISCO ANTERIORE	18.5
CP5469S	2	SUPPORTO DISCO POSTERIORE	18.5
CP5653	3	SOSPENSIONE ELASTICA	0,45
SMI120845	5	STAFFA SUPERIORE SUPPORTO	4,5
SMI121390	4	CUSCINETTO A RULLI	0.3
CP5510	6	FLANGIA MOZZO PER DISCO DA 560 E 610	3.5

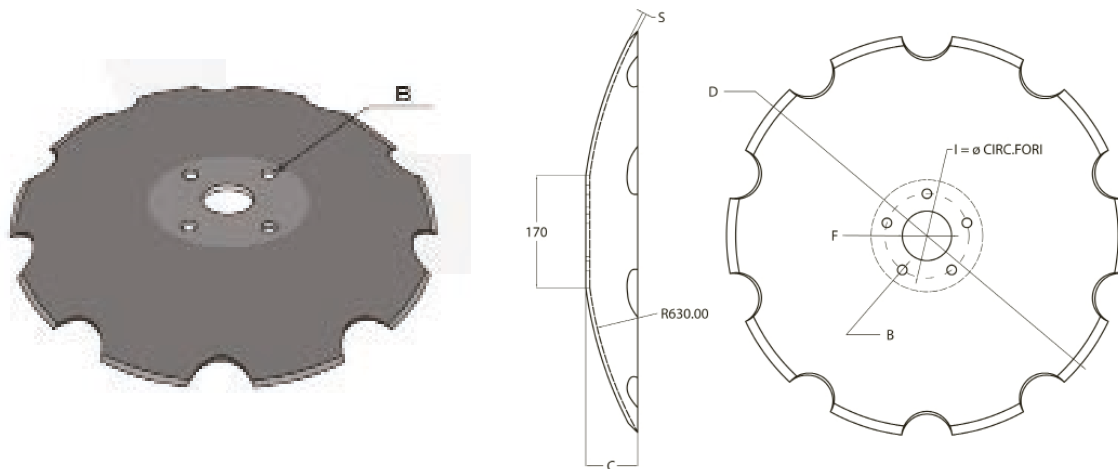
**DISCHI CON BASE PIANA PER ELEMENTO FRANGIZOLLE**
*DISQUES AVEC BASE PLATTE POUR ELEMENTS BRISE -MOTTES*
*SMOOTHED PLATE DISCS FOR DISK HARROW PART*
*EGGENSCHEIBEN GLATT*
*DISCOS CON BASE LLANA PARA ELEMENTO ROTURADOR*

Art./Ref.	Diametro mm/ Diameter mm	Spessore mm/ Thickness mm	Foro mm/ Hole mm	Concavità mm/ Concavity mm	Note/Notes	Fornitore/null
CP1512	460	5	61	44	CIRCONFERENZA PASSANTE SUI 4 FORI MM 115 B=DIAMETRO MM 12,5	D460D5FBP55A
CP1511	510	5	61	54.5	CIRCONFERENZA PASSANTE SUI 4 FORI MM 115 B=DIAMETRO MM 12,5	D510D5FBP55A
CP1513	560	5	75	65	CIRCONFERENZA PASSANTE SUI 5 FORI MM 128 B=DIAMETRO MM 14,5	D560D5FBP55A
CP1510	610	6	75	79	CIRCONFERENZA PASSANTE SUI 5 FORI MM 128 B=DIAMETRO MM 14,5	D610D5FBP56A

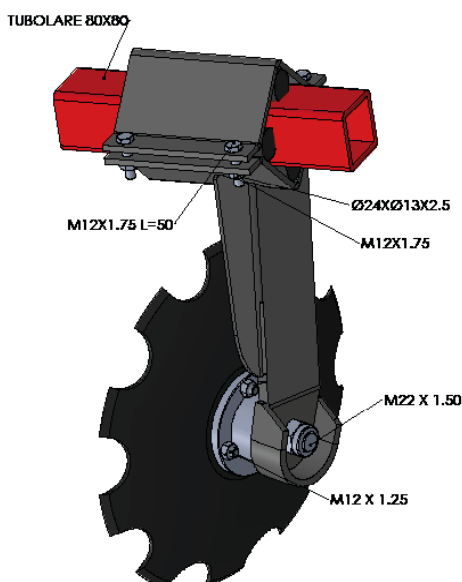
**GRUPPO MOZZO COMPLETO PER ERPICE A DISCHI INDIPENDENTI DA 460 E 510 TUBOLARE 80X80**
*GROUPE MOYEU COMPLET POUR HERSE A DISQUES INDIPENDENTS DE 460 ET 510 TUBULAIRE 80 X 80*
*COMPLETE HUB SET FOR INDIPENDENT DISK HARROW OF 460 AND 510 TUBULAR 80X80*
*NABENGRUPPE KOMPLETT FUER EGGENSCHIEBEN VON 460 BIS 510 ROHR 80X80*
*GRUPO COMPLETO CORONA CENTRAL PARA GRADA CON DISCOS INDEPENDIENTES DE 460 Y 510 - TUBOLAR 80X80*

**NOTE:** Le varie bullonerie in figura sono presenti solo a scopo illustrativo del sistema di montaggio del supporto completo e non vengono forniti come ricambi.

**NOTES:** bolts in figure are only to illustrate the fitting system of the complete support and they are not supplied as spare parts.

Art./Ref.	Titolo Prodotto/Product title
CP3184	ELEMENTO FRANGIZOLLE ANTERIORE CON DISCO DA 460 DENTATO
CP3185	ELEMENTO FRANGIZOLLE POSTERIORE CON DISCO DA 460 DENTATO
CP3186	ELEMENTO FRANGIZOLLE ANTERIORE CON DISCO DA 510 DENTATO
CP3187	ELEMENTO FRANGIZOLLE POSTERIORE CON DISCO DA 510 DENTATO

**ELEMENTO FRANGIZOLLE ANTERIORE E POSTERIORE PER DISCO DA 460 E 510**

ELEMENT BRISE-MOTTES ANTERIEUR ET POSTERIEUR POUR DISQUE DE 460 ET 510

FRONT AND REAR DISK HARROW FOR DISK OF 460 AND 510

VORDER- UND HINTER-EGGENSCHEIBE FUER SCHEIBE AB 460 BIS 510

ELEMENTO ROTURADOR ANTERIOR Y POSTERIOR PARA DISCO DE 460 Y 510

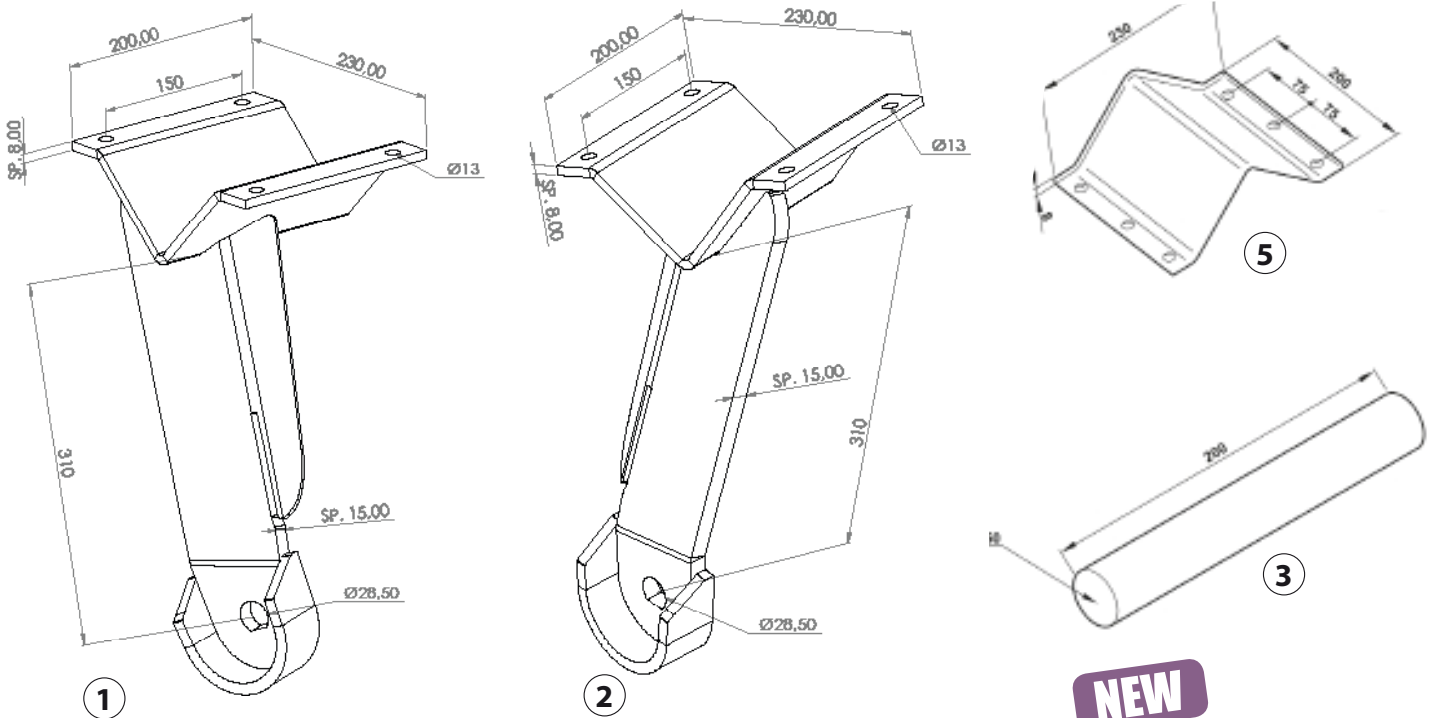

Art./Ref.	Pos.	Titolo Prodotto/Product title	Peso Kg/Weight Kg
CP3188	1	SUPPORTO DISCO ANTERIORE	12,5
CP3189	2	SUPPORTO DISCO POSTERIORE	12,5
CP5653A	3	SOSPENSIONE ELASTICA	0,25
CP6624	4	MOZZO FRANGIZOLLE 4 FORI SKF	2,25
SMI120848	5	STAFFA SUPERIORE SUPPORTO	4

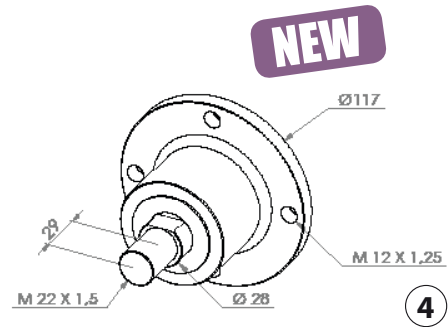

**GRUPPO MOZZO COMPLETO PER ERPICE A DISCHI INDIPENDENTI DA 560 E 610 TUBOLARE 100X100**

GROUPE MOYEU COMPLET POUR HERSE A DISQUES INDIPENDENTS DE 560 ET 610 TUBULAIRE 100 X 100

COMPLETE HUB SET FOR INDEPENDENT DISK HARROW OF 560 AND 610 TUBULAR 100X100

NABENGRUPPE KOMPLETT FUER EGGENSCHIBEN VON 560 BIS 610 ROHR 100X100

GRUPO COMPLETO CORONA CENTRAL PARA GRADA CON DISCOS INDEPENDIENTES DE 560 Y 610 - TUBULAR 100X100

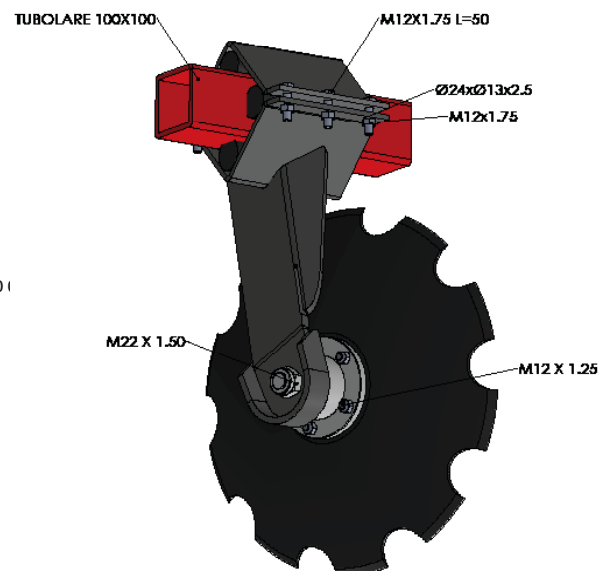

**NOTE:** Le varie bullonerie in figura sono presenti solo a scopo illustrativo del sistema di montaggio e supporto completo e non vengono forniti come ricambi.

**NOTES:** bolts in figure are only to illustrate the fitting system of the complete support and they are not supplied as spare parts.

Art./Ref.	Titolo Prodotto/Product title
CP3190	SUPPORTO ANTERIORE CON DISCO DA 560 DENTATO
CP3191	SUPPORTO POSTERIORE CON DISCO DA 560 DENTATO
CP3192	SUPPORTO ANTERIORE CON DISCO DA 610 DENTATO
CP3193	SUPPORTO POSTERIORE CON DISCO DA 610 DENTATO

**ELEMENTO FRANGIZZOLE ANTERIORE E POSTERIORE PER DISCO DA 560 E 610**

ELEMENT BRISE-MOTTES ANTERIEUR ET POSTERIEUR POUR DISQUE DE 560 ET 610

FRONT AND REAR DISK HARROW FOR DISC OF 560 AND 610

VORDER- UND HINTER-EGGENSCHEIBE FUER SCHEIBEN AB 560 UND 610

ELEMENTO ROTURADOR ANTERIOR Y POSTERIOR PARA DISCO DE 560 Y 610

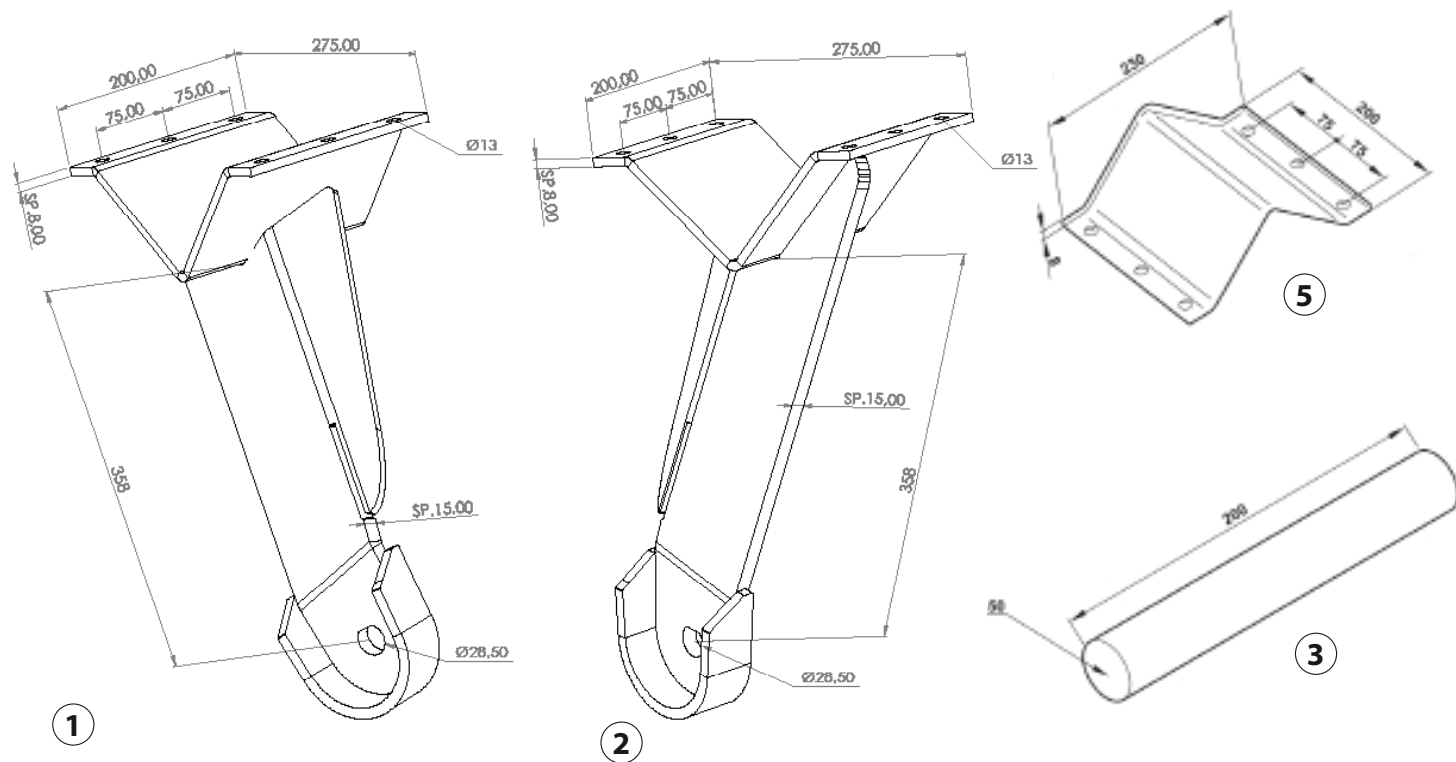

Art./Ref.	Pos.	Titolo Prodotto/Product title	Peso Kg/Weight Kg
CP3197	1	SUPPORTO DISCO ANTERIORE	18,5
CP3198	2	SUPPORTO DISCO POSTERIORE	18,5
CP5653	3	SOSPENSIONE ELASTICA/ELASTIC SUSPENSION	0,45
CP6625	4	MOZZO FRANGIZOLLE 5 FORI SKF	2,25
SMI120845	5	STAFFA SUPERIORE SUPPORTO/UPPER BRACKET SUPPORT	4,5

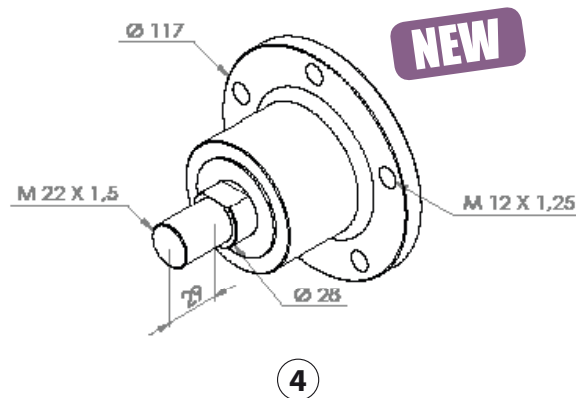

**DISCHI CON BASE PIANA PER ELEMENTO FRANGIZZOLLE**

DISQUES AVEC BASE PLATTE POUR ELEMENTS BRISE-MOTTES

SMOOTHED PLATE DISCS FOR DISK HARROW PART

EGGENSCHEIBEN GLATT

DISCOS CON BASE LLANA PARA ELEMENTO ROTURADOR

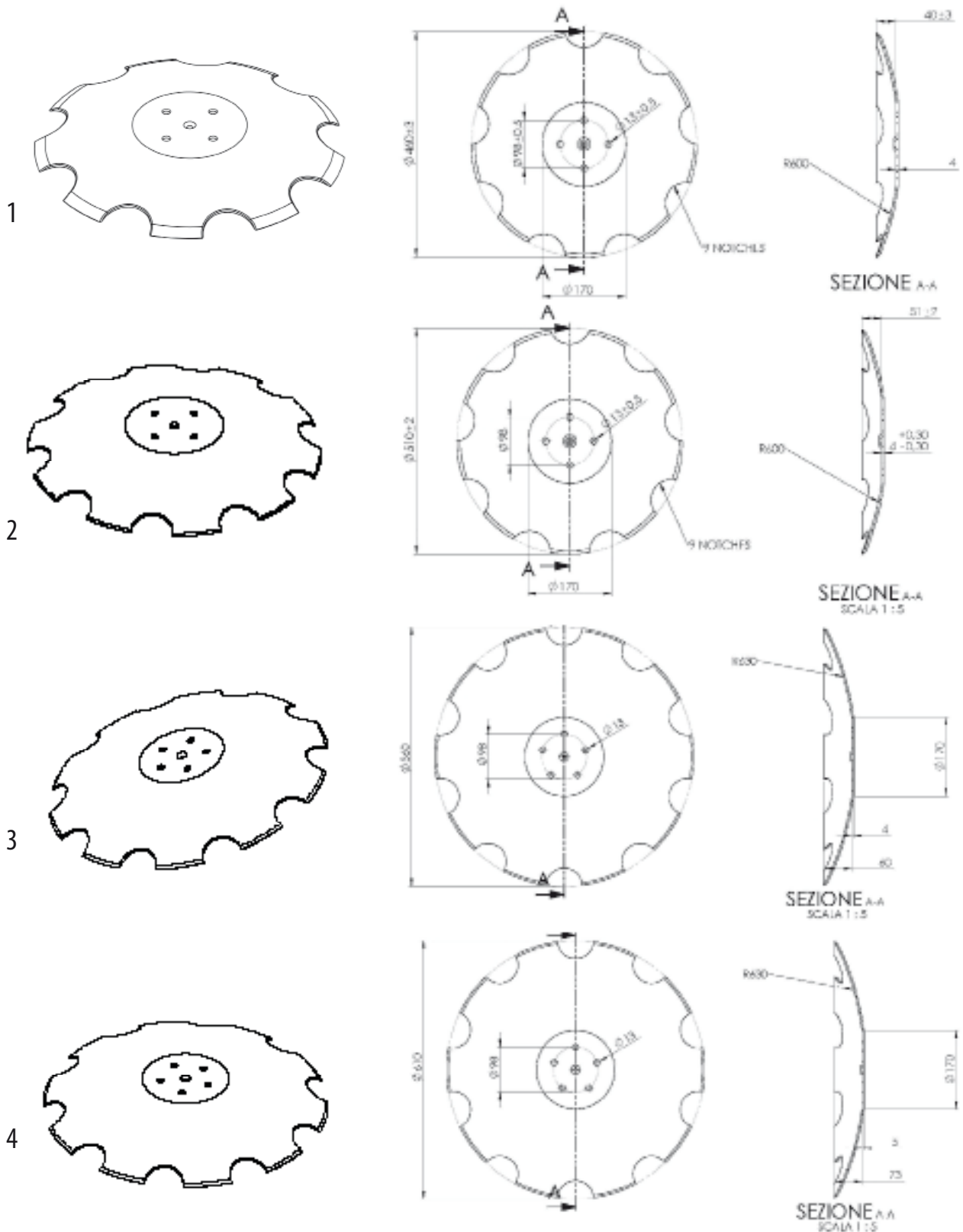

Art./Ref.	Pos.	Diametro mm/ Diameter mm	Spessore mm/ Thickness mm	Concavità mm/ Concavity mm	Brand	Fornitore/null
CP2976	1	460	4	40	NUOVA AZZIMONDI & FR	D460DBP4FS4A
CP2977	2	510	4	50	NUOVA AZZIMONDI & FR	D510DBP4FS4A
CP2978	3	560	4	60	NUOVA AZZIMONDI & FR	D560DBP5FS4R63A
CP2979	4	610	5	73	NUOVA AZZIMONDI & FR	D610DBP5FS5R63A

**SUPPORTO MOLLEGGIATO PER ERPICE A DISCHI DA 560 TUBOLARE 80X80**

SUPPORT SUSPENDU POUR HERSE DISQUE DE 560 TUBULAIRE 80 X 80

SPRUNG SUPPORT FOR HARROW DISC OF 560 TUBULAR 80X80

ZINKEN-HALTER GEFEDERT FUER LEICHTEN VON 560 ROHR 80X80

SOPORTE AMORTIGUADOR PARA ERPICE CON DISCOS DE 560 - TUBOLAR 80X80

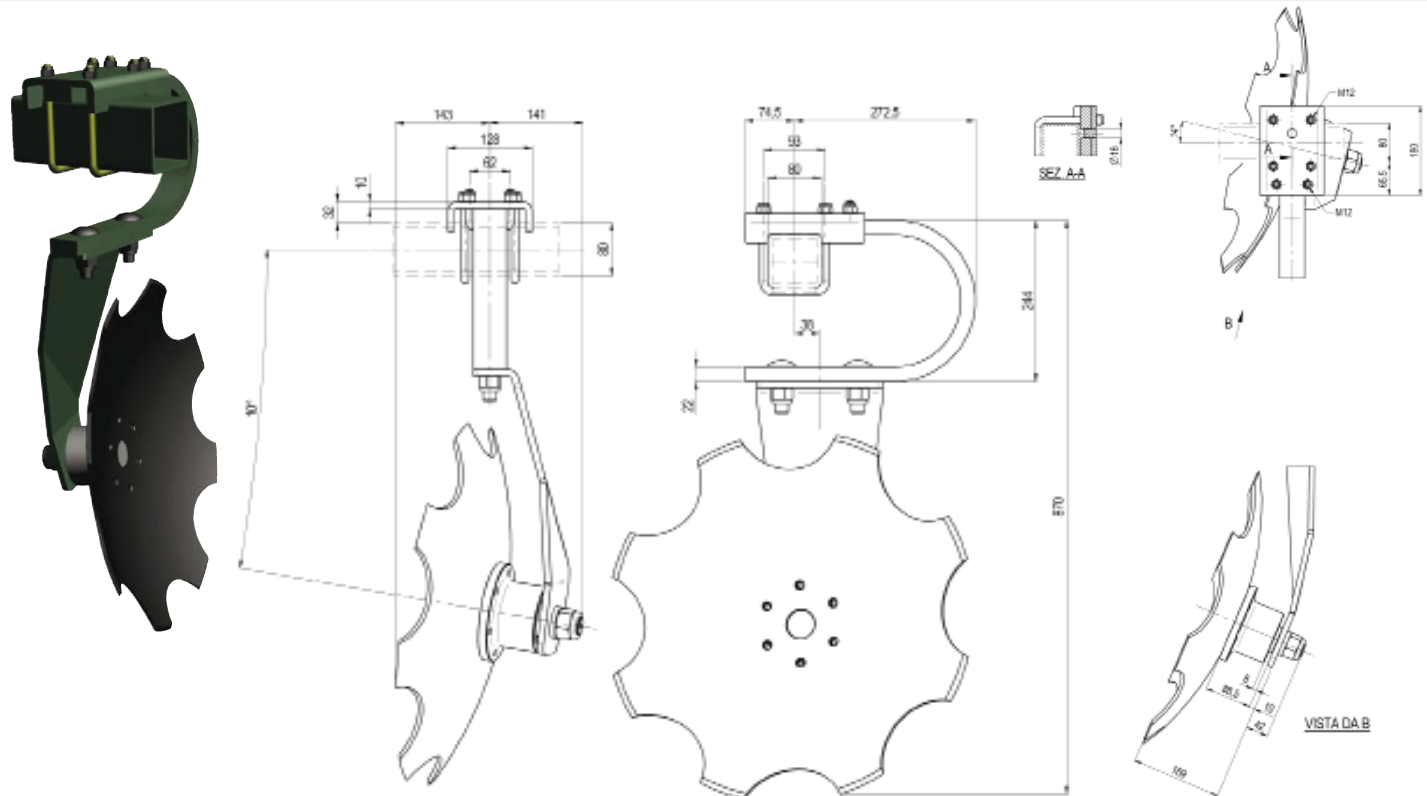

Art./Ref.	Titolo Prodotto/Product title	Diametro mm/ Diameter mm	Spessore mm/ Thickness mm	Foro mm/ Hole mm	Concavità mm/ Concavity mm	Note	Fornitore/null
<b>CP6196</b>	SUPPORTO MOLLEGGIATO COMPLETO DI DISCO DX					Modello in figura DX	
<b>CP6196S</b>	SUPPORTO MOLLEGGIATO COMPLETO DI DISCO SX						
<b>CP6194</b>	MOZZO PORTADISCO						
<b>CP6207A</b>	DISCO CAMOMILLA BISELLO TIPO A	560	5 mm	45	74	Disco con n.6 fori da 13,5 mm ,interasse 120 mm. Bisello tipo A	D560DT45F135SSA



**SUPPORTO MOLLEGGIATO PER ERPICE A DISCHI DA 560 TUBOLARE 100X100**

SUPPORT SUSPENDU POUR HERSE DISQUE DE 560 TUBULAIRE 100 X 100

SPRUNG SUPPORT FOR HARROW DISC OF 560 TUBULAR 100X100

ZINKEN-HALTER GEFEDERT FUER LEICHTEN VON 560 ROHR 100X100

SOPORTE AMORTIGUADOR PARA ERPICE CON DISCOS DE 560 - TUBOLAR 100X100

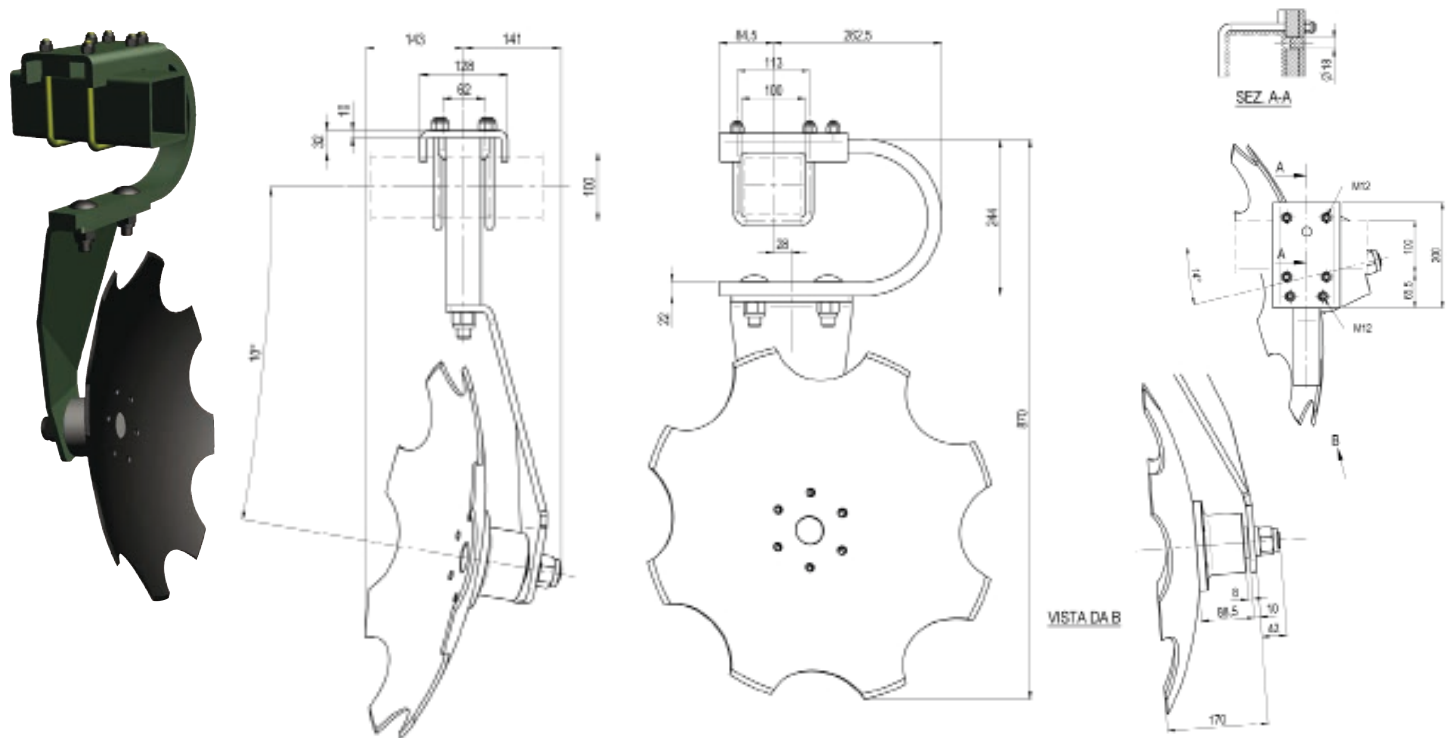

Art./Ref.	Titolo Prodotto/Product title	Diametro mm/ Diameter mm	Spessore mm/ Thickness mm	Foro mm/ Hole mm	Concavità mm/ Concavity mm	Note	Fornitore/null
CP6192	SUPPORTO MOLLEGGIATO COMPLETO DI DISCO DX					Modello in figura DX	
CP6192S	SUPPORTO MOLLEGGIATO COMPLETO DI DISCO SX						
CP6194	MOZZO PORTADISCO						
CP6207A	DISCO CAMOMILLA BISELLO TIPO A	560	5 mm	45	74	Disco con n.6 fori da 13,5 mm ,interasse 120 mm. Bisello tipo A	D560DT45F135SSA

**STELO PER ELEMENTO FRANGIZZOLLE ADATTABILE ALLA PRODUZIONE LEMKEN**

BARRE DE SUPPORT POUR SYSTÈME DE DÉCHAUMAGE À DISQUE LEMKEN

LEG FOR DISC HARROW SUITABLE TO LEMKEN

ZINKEN HALTERUNG PASSEND FUER LEMKEN SCHEIBENEGGE

VÁSTAGO PARA GRADA DE DISCOS ADAPTABLE A LA PRODUCCIÓN LEMKEN



Art./Ref.	Titolo Prodotto/Product title	Brand	Rif. Orig./Orig. Ref.
RC2098	STELO 60x25x900 DX	LEMKEN	4128170
RC2099	STELO 60x25x900 SX	LEMKEN	4128171